





Innovative Designs for Sustainable Wellness



As flexible workspaces become more prevalent with new work arrangements, prioritizing ergonomic design is essential for enhancing comfort, health, and wellbeing. By adapting tools to fit the body rather than forcing the body to adapt to tools, we can create energetic and dynamic environments that foster creativity and innovation. The human body has naturally evolved for regular movement, and prolonged periods of sitting or standing can adversely affect its health.

Save More Space Than Normal Workstation

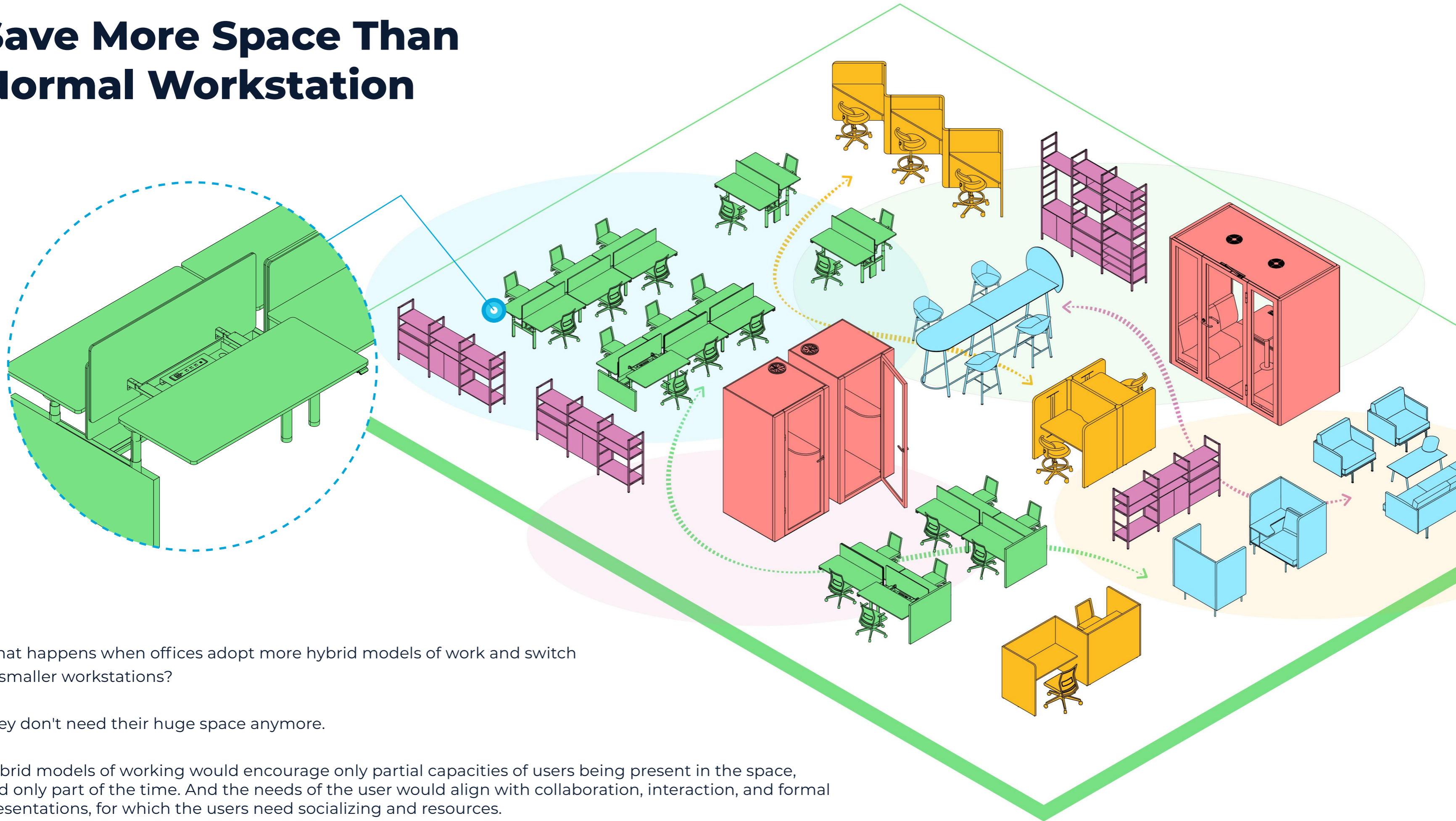

What happens when offices adopt more hybrid models of work and switch to smaller workstations?

They don't need their huge space anymore.

Hybrid models of working would encourage only partial capacities of users being present in the space, and only part of the time. And the needs of the user would align with collaboration, interaction, and formal presentations, for which the users need socializing and resources.

So the offices of this speculation would reduce their property footprint as well as their ecological footprint, instead opting to become smaller spaces largely meeting/interaction-oriented spaces with much smaller areas of individual working for the times when they are needed.

INTRODUCING

Introduction

Jute

A: DESK FRAME & MOTOR — P07-P08→

3 stage electric height adjust, rectangular and round column are available.

B: TABLE TOP — P09-P10→

Desk with sliding feature to increase usable area, reduce costs, and provide more workspace.

C: FLOOR CABLING BOX — P11-P12→

With better wire management, concealing cable from ground to the table.

D: DESK BASE CABLE DUCT — P11-P12→

Hanging cable duct for power sockets under the table top, easily future maintenance.

E: BRIDGE CABLE DUCT — P11-P12→

Integrated power and movable cover for easily future maintenance.

F: METAL CABLING TRACK — P11-P12→

Bionic arm design for easy wiring, quiet lifting, and eco-friendliness.

G: SCREEN OPTIONS — P13-P14→

Various materials available, can be fixed or movable.

H: ACCESSORIES — P15-P16→

Efficient office setup with more diverse configurations: book stand, CPU holder, monitor arm...

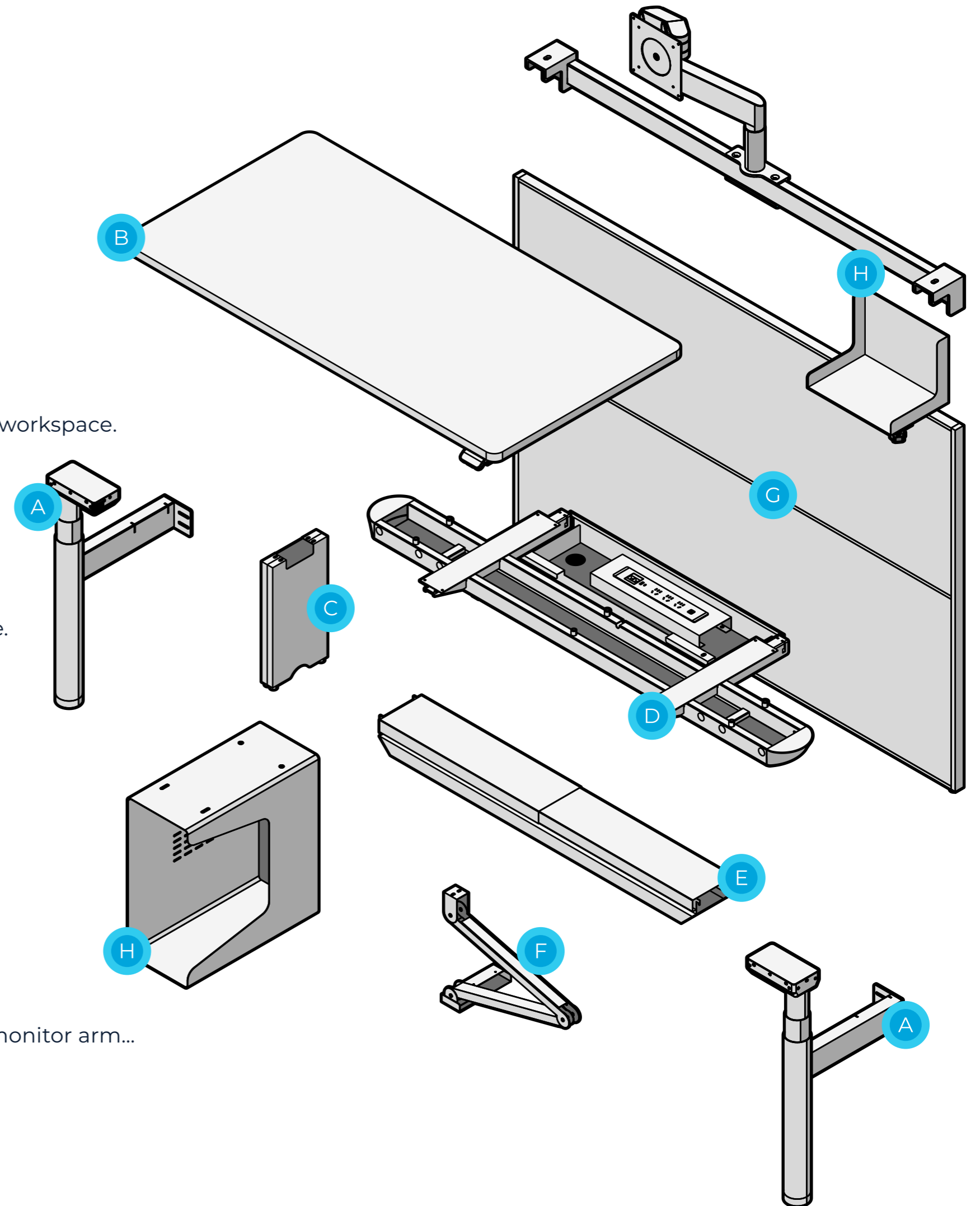

Desk Frame & Motor



Effortless cool and comfort

To meet the diverse functional needs of different jobs, Jute is designed for ease of use and to accommodate every body type. Jute offers adjustable height settings to ensure physical and mental comfort in the workplace. It meets individual needs and adapts to team environments with desks and tables of various sizes that can be easily adjusted between standing and sitting positions, making it suitable for private offices, collaborative spaces, and meeting areas. Jute supports different types of connections, encouraging awareness, interaction, and collaboration among people and teams.

Product features

Desk Frame Lift Range:	Square:595-1245MM/Round:605-1255MM
Frame Extension Range:	1080-1800MM
Compatible Panel:	W1200-2000*D600-800mm
Foot Length:	600/700MM
Maximum Load Capacity and Speed:	125kg and 40MM/s
Low Noise Level:	<50 dB (empty load)
Standby Power Consumption:	<0.1W
Surface Finish:	Powder-coated in White, Black, Gray

Intuitive control experience

- Four memory settings.
- Preset height.
- Digital display.
- Breathing reminder.
- Blue function.



No matter full or empty load

- Control system stability.
- Clever structural design.
- Smooth lifting even with or without 100 KG loading.



High precision with obstacle rebound

- Anti-Collision lifting solution.
- Patented tech with dual protection for rapid detection.
- Providing comprehensive, high-level lifting safety experience.



Sustainable carbon neutrality

- Our principles of ME WE (Materials, Energy, Waste Emissions) give us a simple way to think about how our operations impact the environment.
- 0.1 W Ultra-Low Standby Power Consumption Technology.
- Reduced energy consumption (approximately 3.7 kWh per unit per year) and lower carbon emissions (approximately 3 kg CO₂ per unit per year).



Plus X Award 2018.
German Innovation Award 2018.
Reddot Design Award 2018.

Click the title or play button for more details →

Table Top

Clean and Organized Desk

JUTE's unique design eliminates the need for cable grommets on the desk, thereby increasing the usable surface area and reducing production costs. It provides more convenient access to power, a larger workspace, and a more pleasant experience.



Jute offers a 150mm tabletop sliding stroke, increasing the tabletop area without changing its size, while maintaining reliable stability.

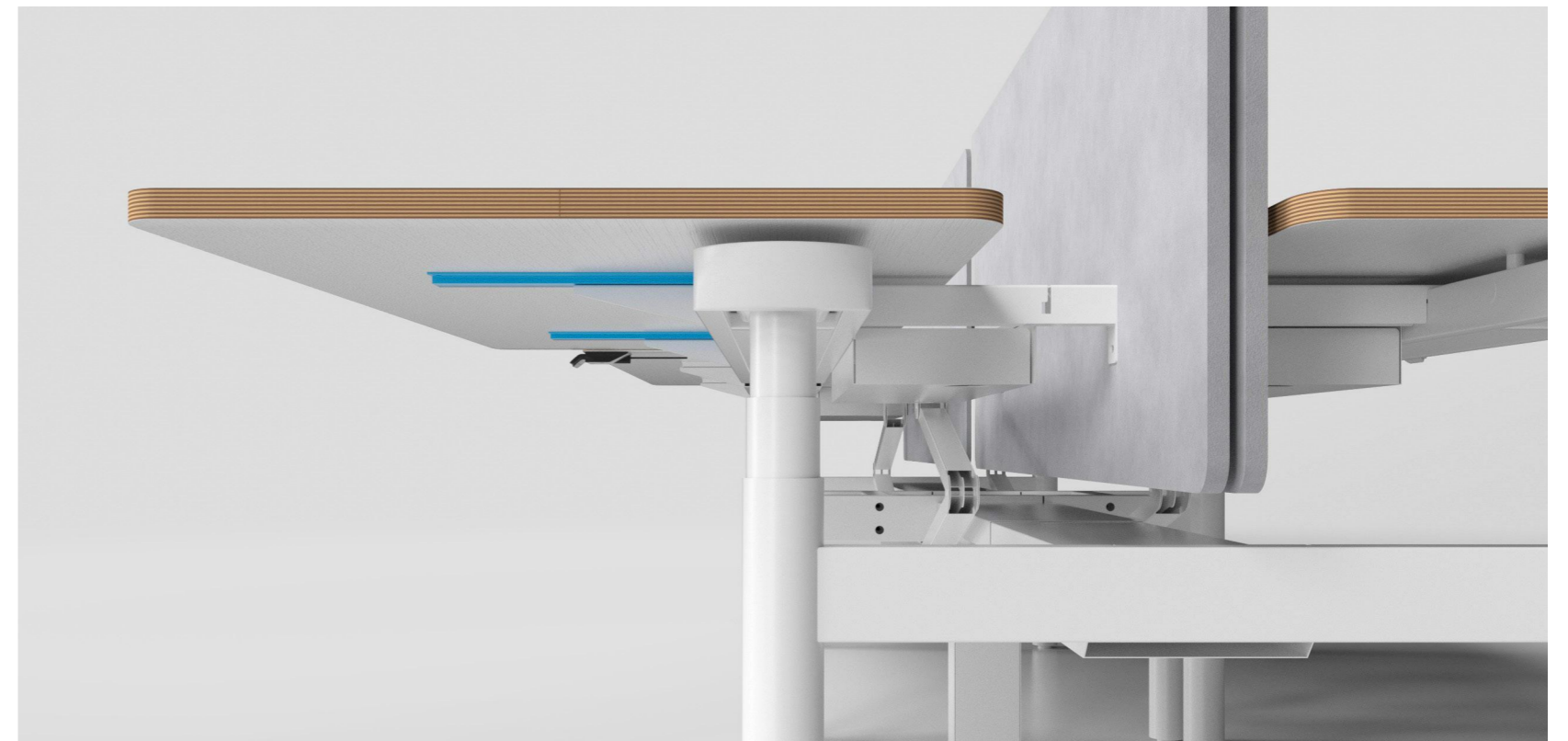

JUTE offers various desktop shapes to choose from.

Straight corner, Beveled edge.A

Melamine, marine plywood is an option
W1200-2000*D600-800*25MM

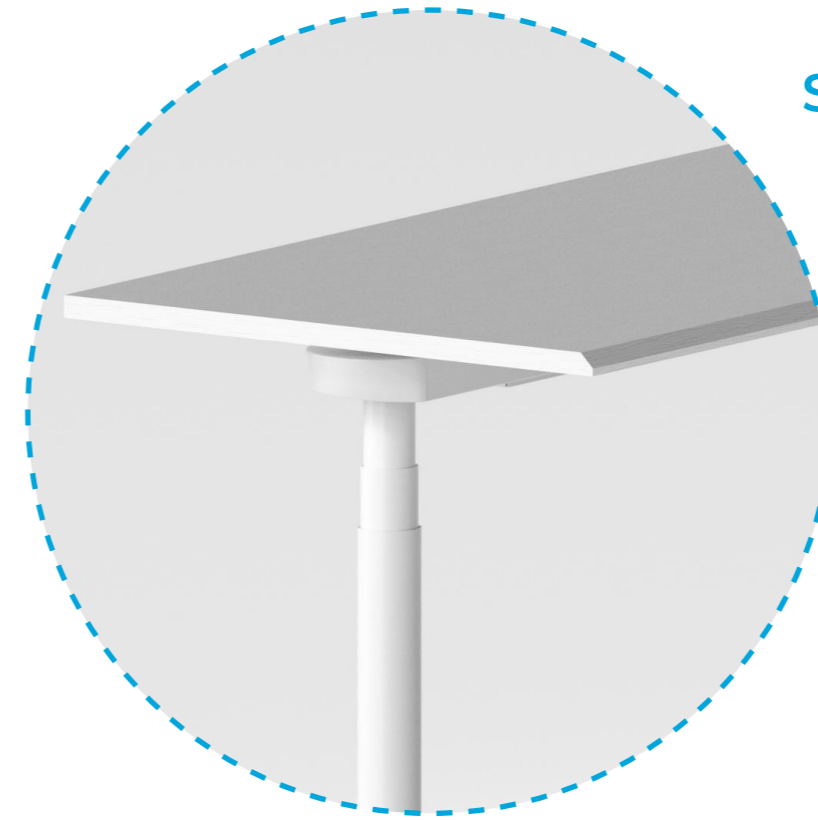
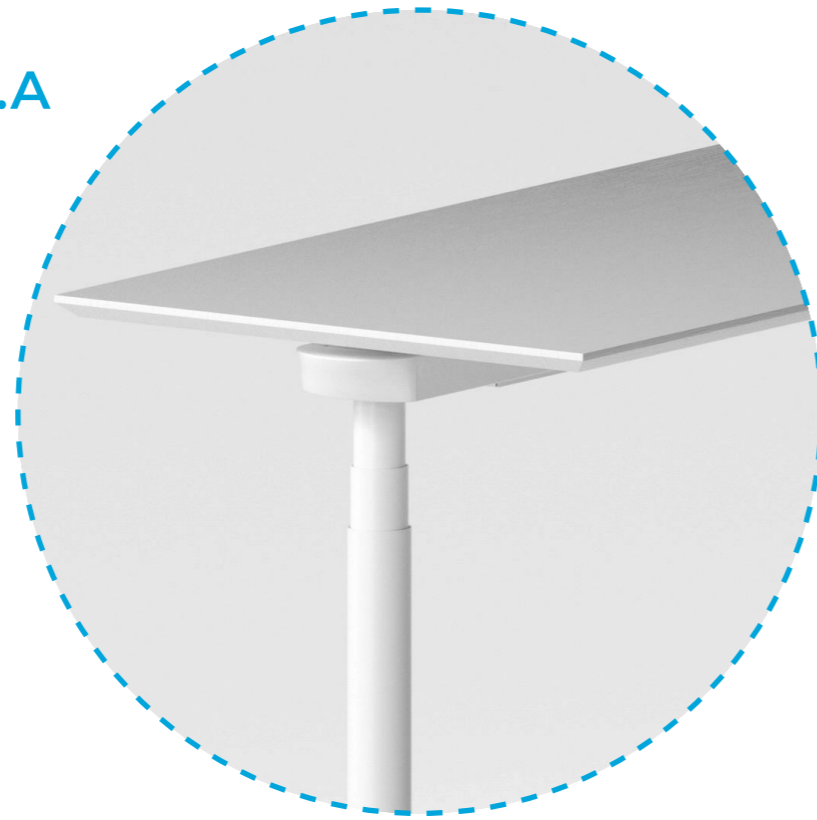
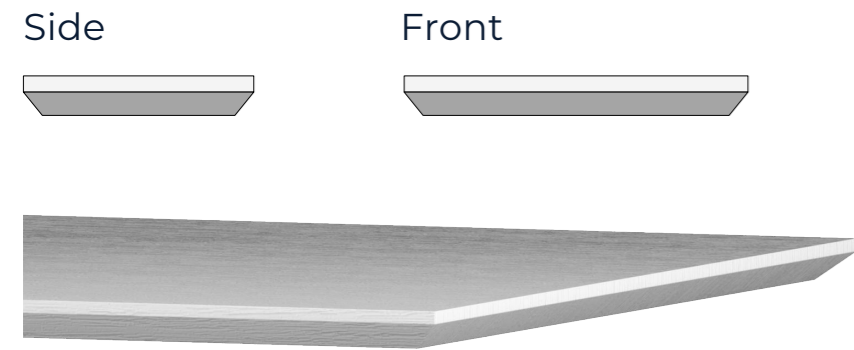

Straight corner, Beveled edge.B

Melamine, marine plywood is an option
W1200-2000*D600-800*25MM

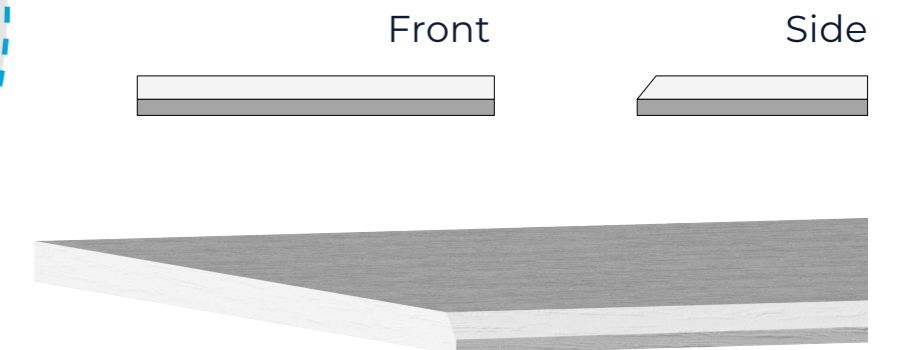

Round corner, straight edge

Melamine, marine plywood is an option
W1200-2000*D600-800*25MM

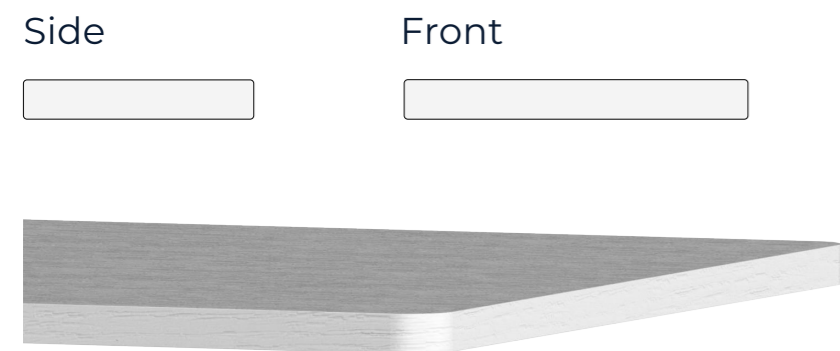

Round Corner, Beveled edge

Melamine, marine plywood is an option
W1200-2000*D600-800*25/18MM

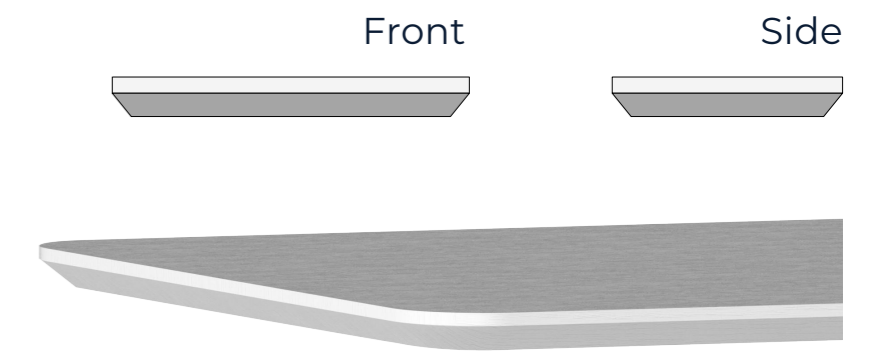

Cable Management

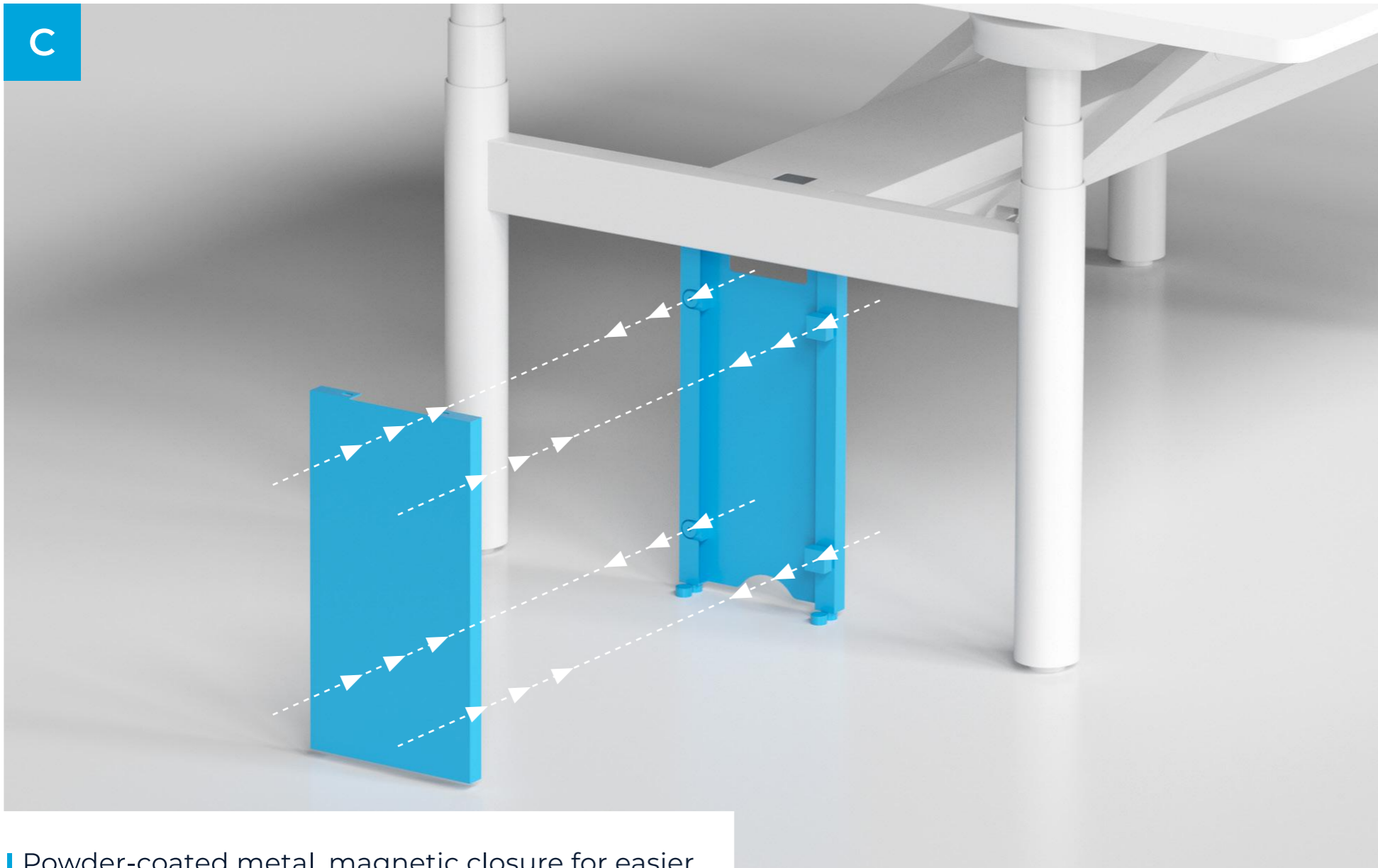

■ Powder-coated metal, magnetic closure for easier assembly and disassembly, different table configurations with corresponding sizes.



■ Clean and Tidy Cable Management.

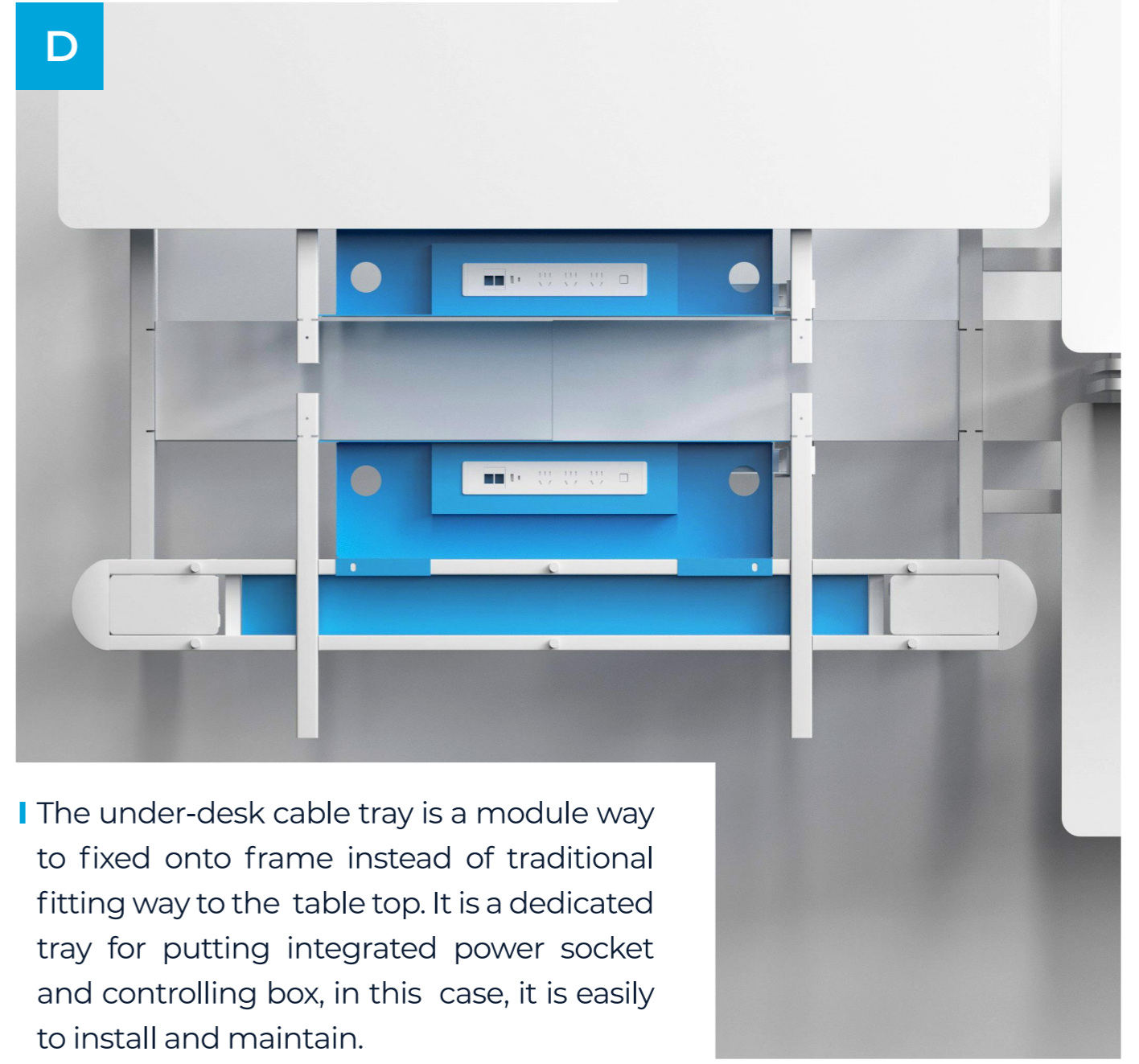

■ The under-desk cable tray is a module way to fixed onto frame instead of traditional fitting way to the table top. It is a dedicated tray for putting integrated power socket and controlling box, in this case, it is easily to install and maintain.

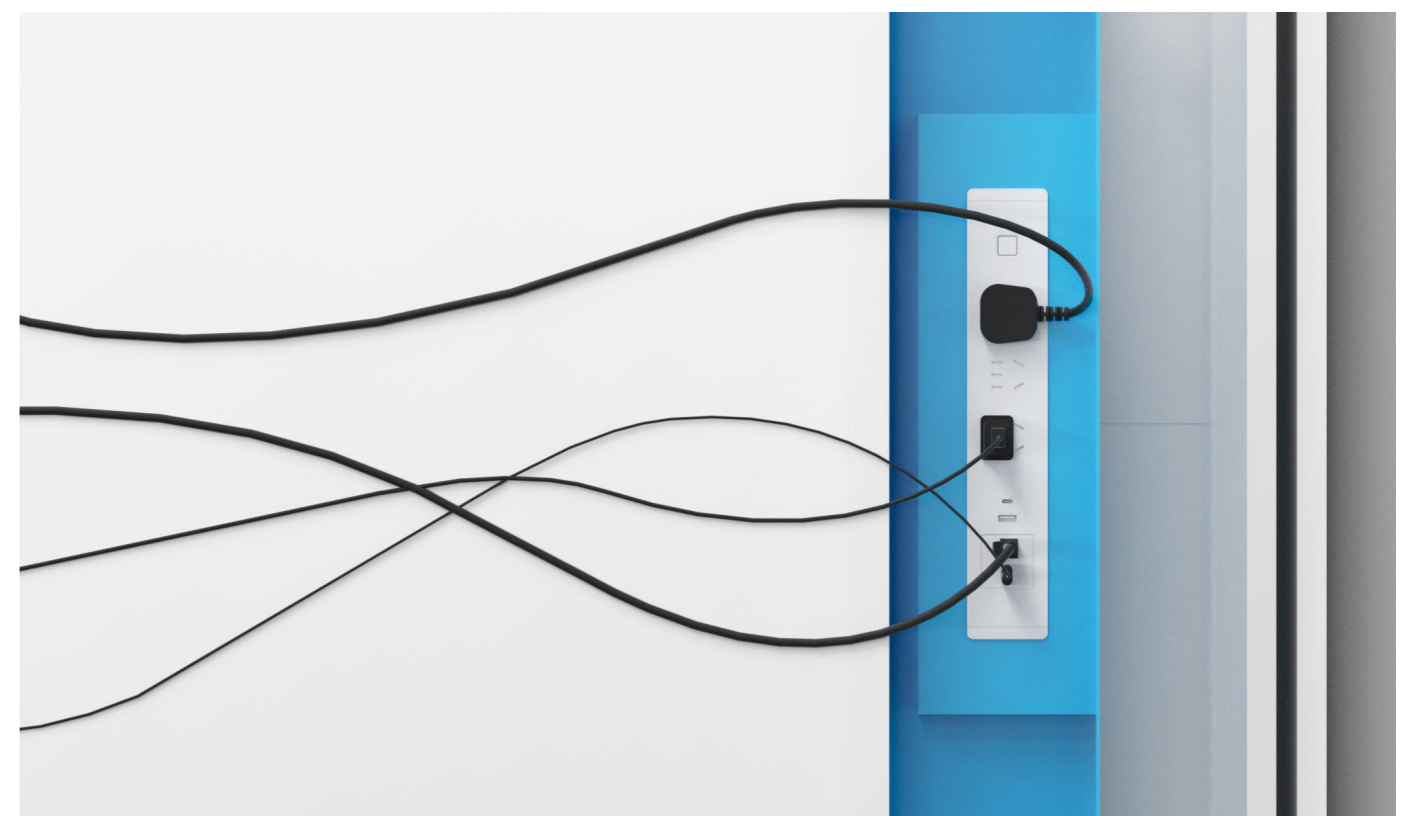

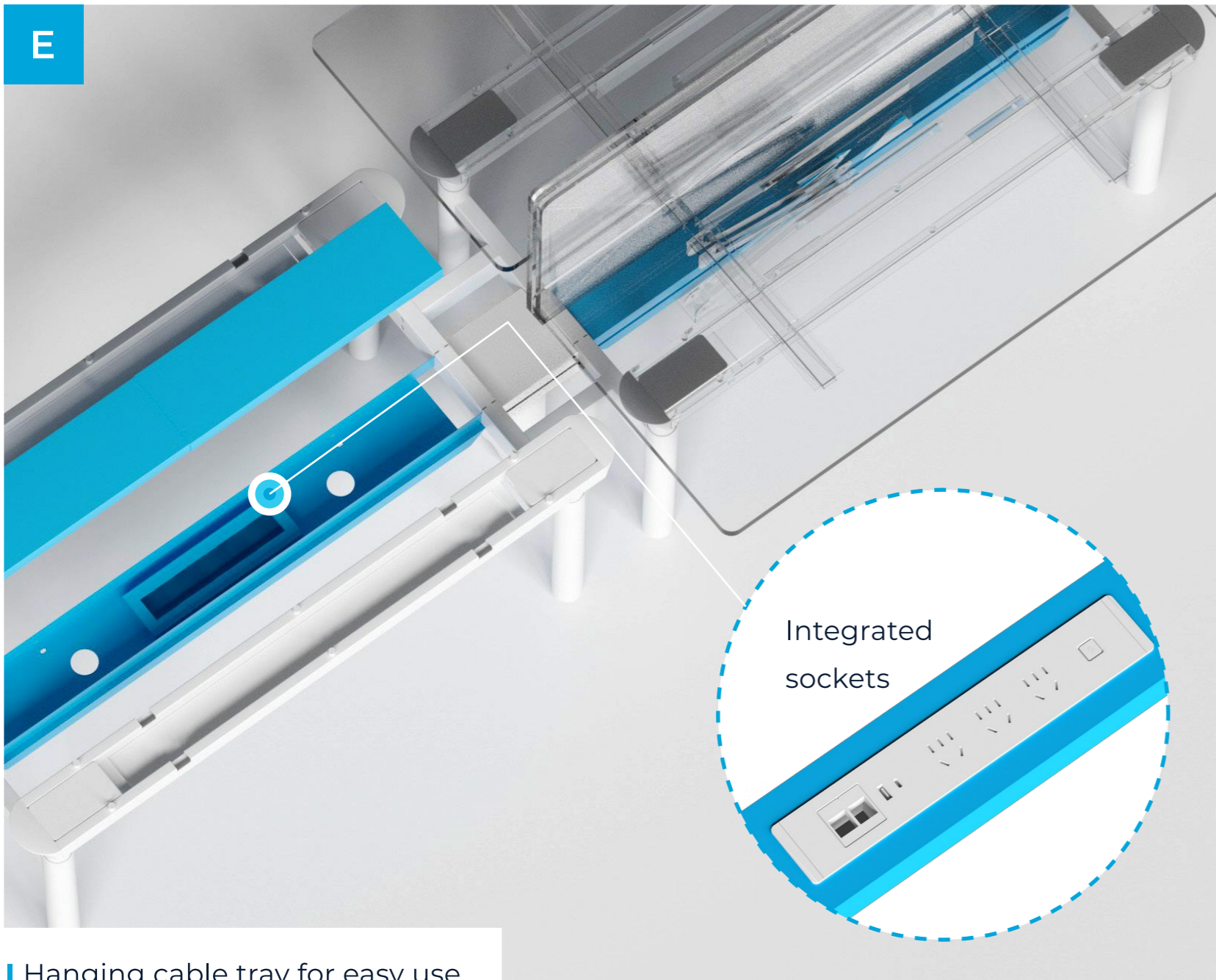

■ Hanging cable tray for easy use angled bottom for easier entry, removable top for more space, avoids cross-work.

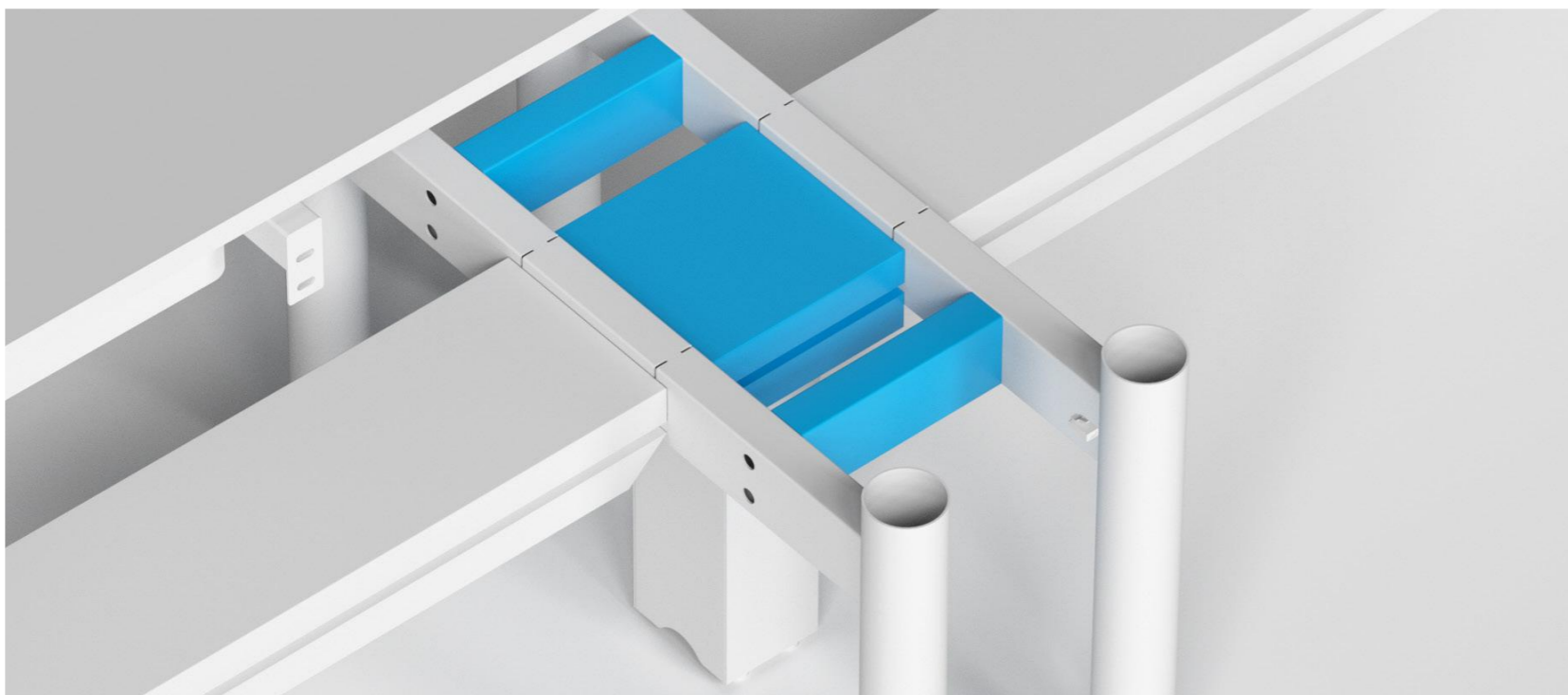

■ Closed cable tray between the back to back workstation for the safety connections.

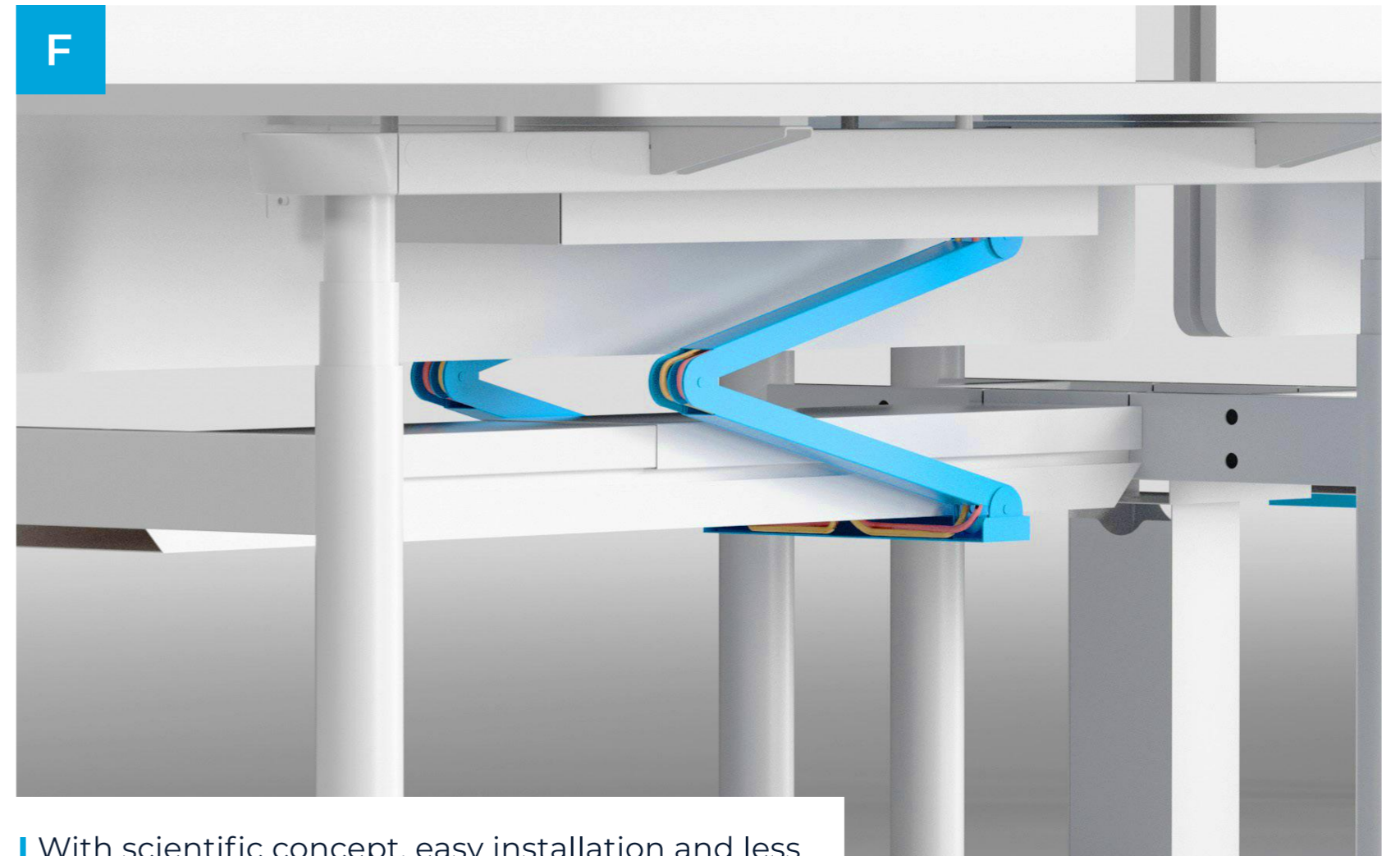

■ With scientific concept, easy installation and less noise when lifting, a bionic design is for a better wire management.

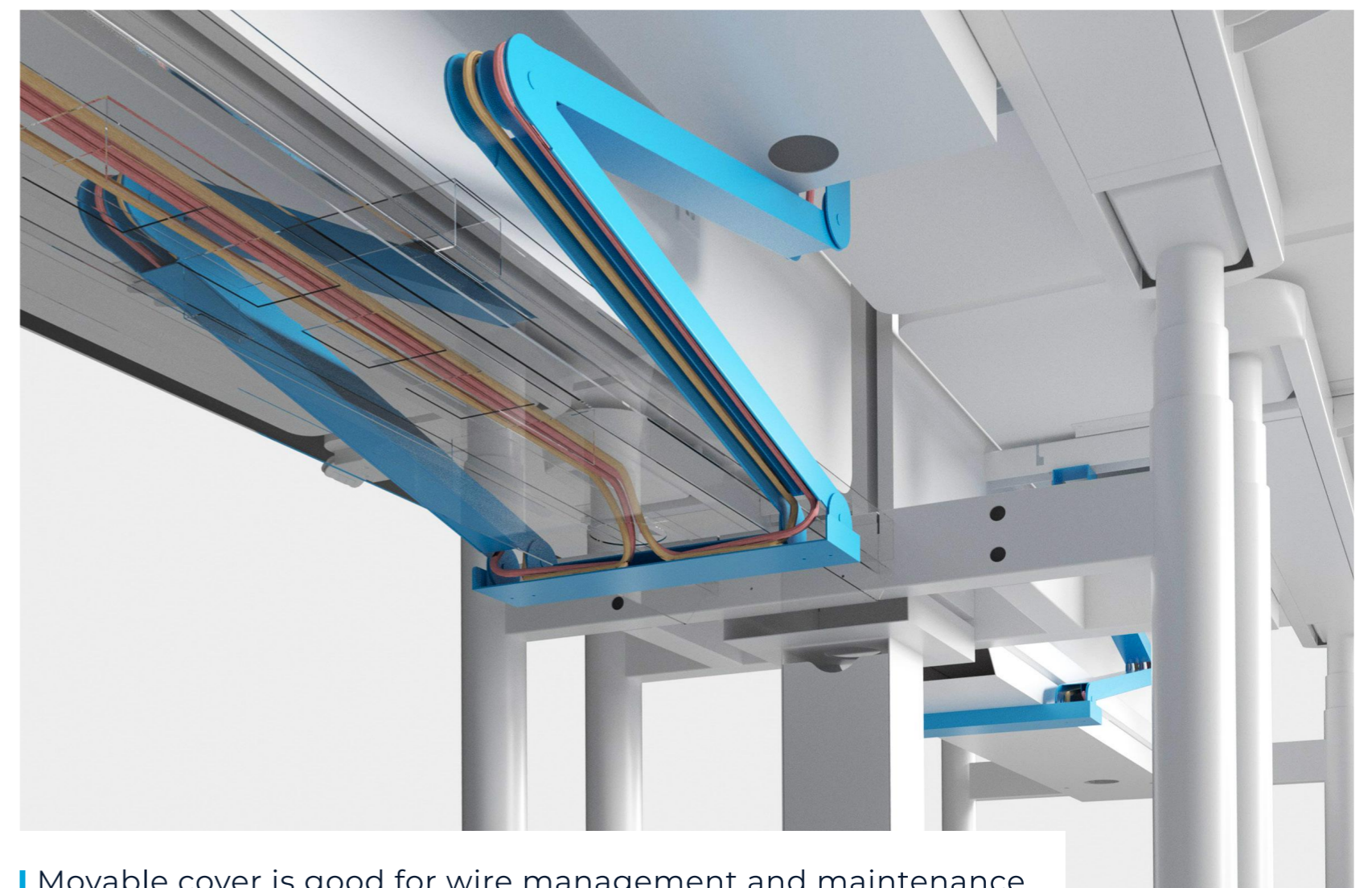

■ Movable cover is good for wire management and maintenance.

Screen Options

Straight Screen

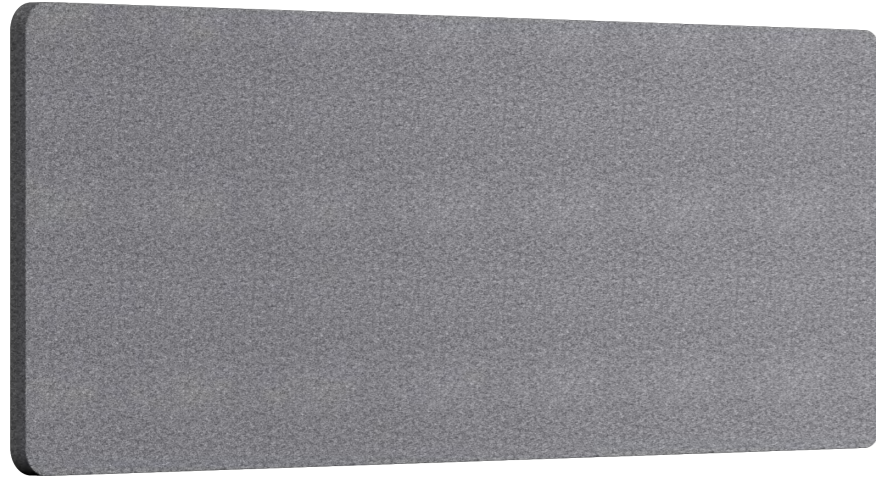

Acoustic Screen

12/18/24MM

Modesity panel (S2S)
Hanging screen (S2S, B2B)
Fixed on the bridge (B2B)

Taylor made/ Standard

H350/400/500MM
H500MM
H680MM

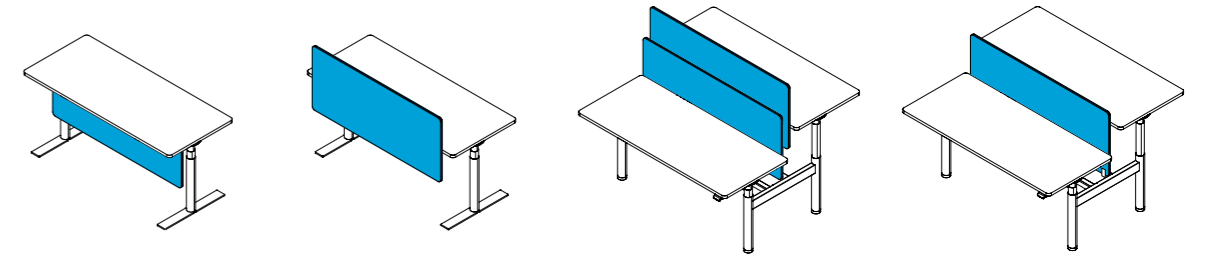

Upholstery Screen

18/25MM

Modesity panel (S2S)
Hanging screen (S2S, B2B)
Fixed on the bridge (B2B)

Standard

H350/400/500MM
H500MM
H680MM

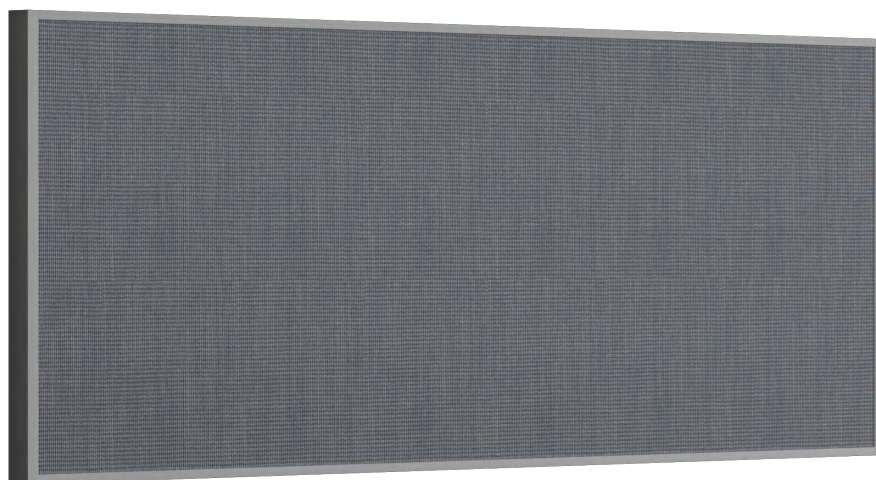
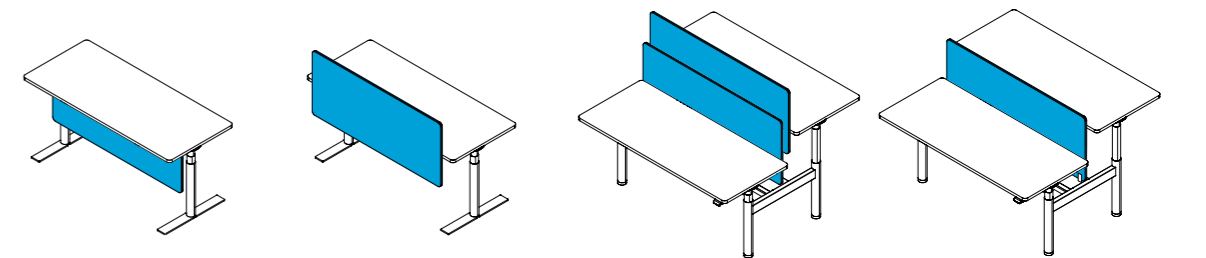

Alu Frame Screen

28/30/40/50/60MM

Screen to the floor (S2S)
Fixed on the bridge (B2B)

Standard

H1150MM
H680MM

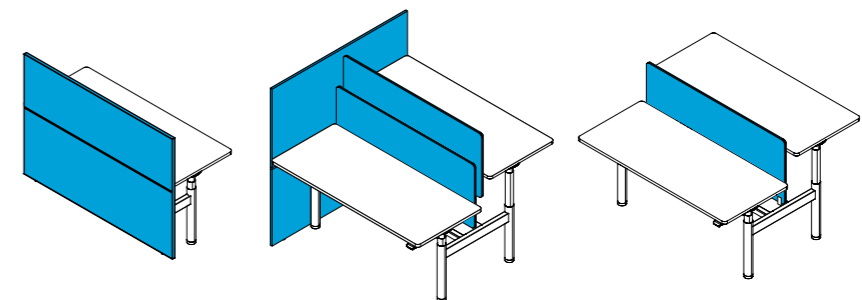

Design Screen

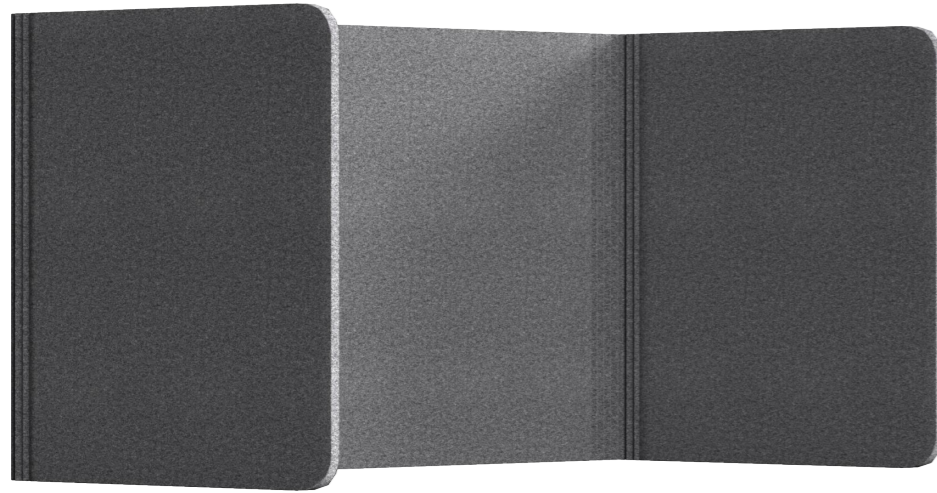

Acoustic Screen-Full Wrap

12MM: 2=2*12MM Max individual expand width up to 2800mm

Hanging screen (S2S, B2B)

H600/750MM

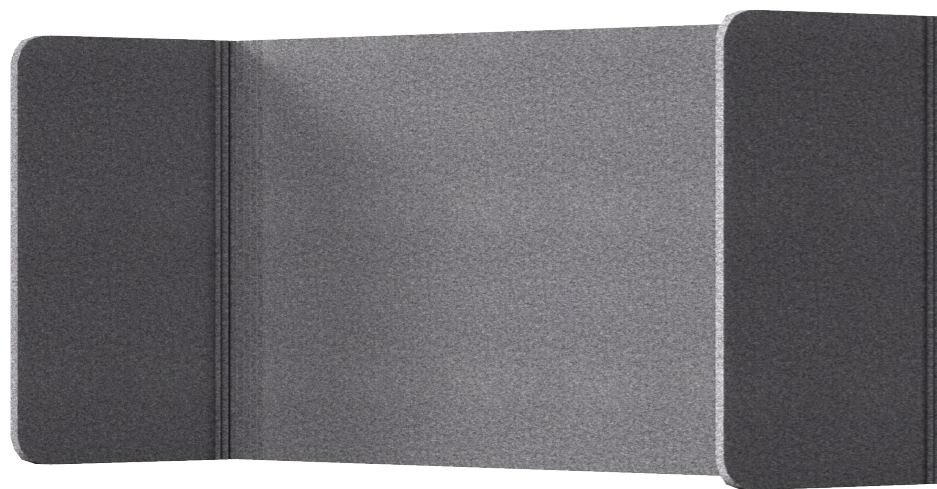
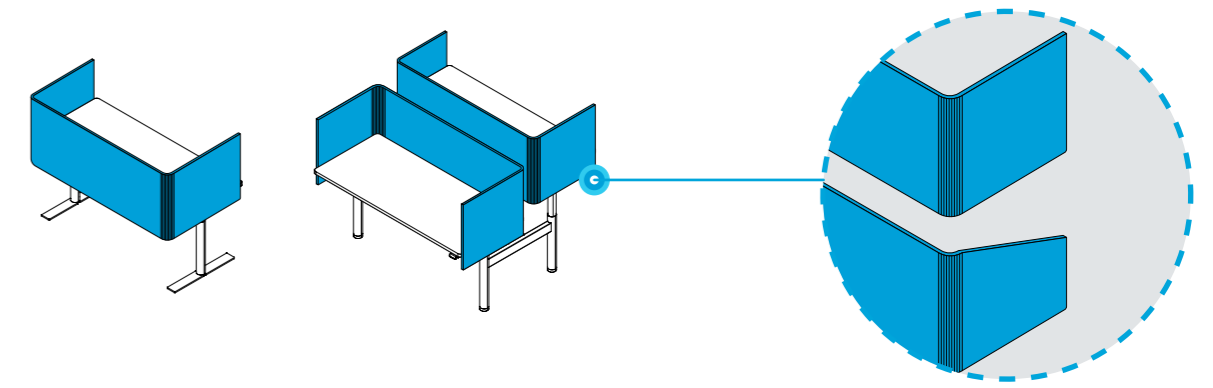

Acoustic Screen-Semi Wrap

12MM: 2=2*12MM Screen depends on table; Curve: 250MM

Hanging screen (S2S, B2B)

H600/750MM

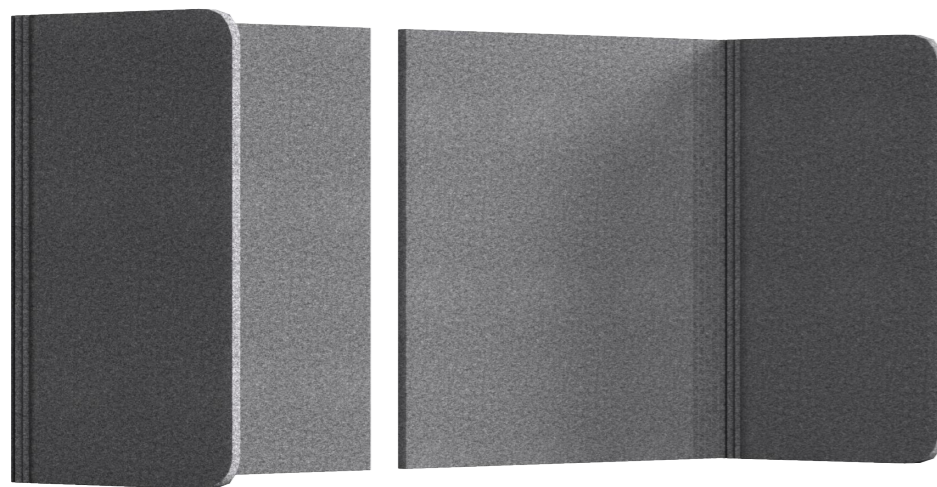
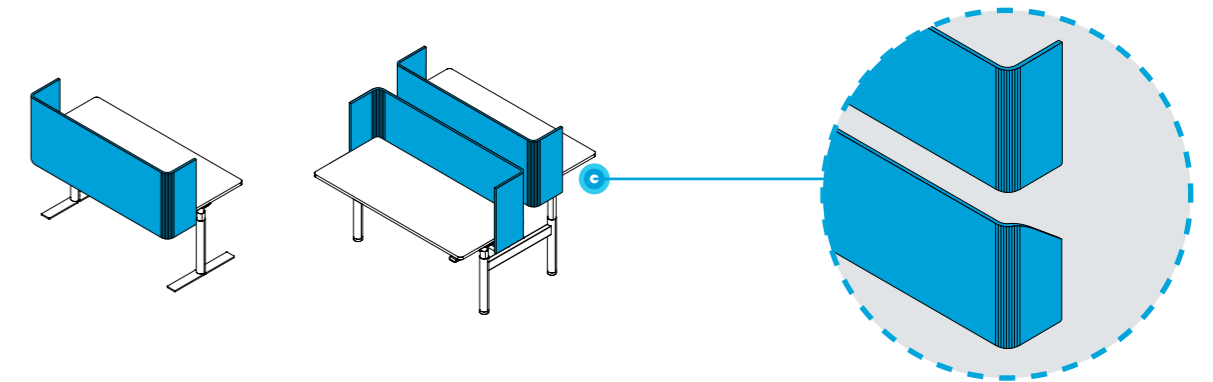

Acoustic Screen-Z type

12MM: 2=2*12MM Half of the table; Curve: 250MM

Hanging screen (S2S, B2B)

H600/750MM

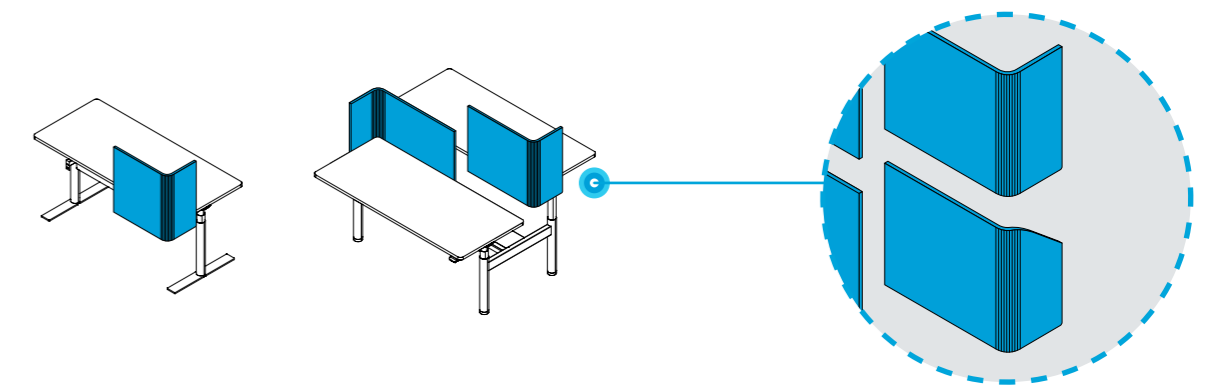

Straight or bevel edge are optional for the sides.

Accessories

Efficient Workstation with Functional Features

The spacious workspace enhances efficiency, supporting seamless multitasking. With the options for adding the CPU holder, monitor arm or other accessories, it promotes a healthier and more comfortable working posture, boosting productivity.



LIGHTING



4000K lighting, dimmable, concealed input outlet.

BOOKSTAND



Functional integrated, different sizes available.

MONITOR ARM



360° rotatable, single/dual screen options available.

DECORATIVE SIDE LEG



■ Create the privacy between the workstation to the path by using the magnetic side panel.

EDGE

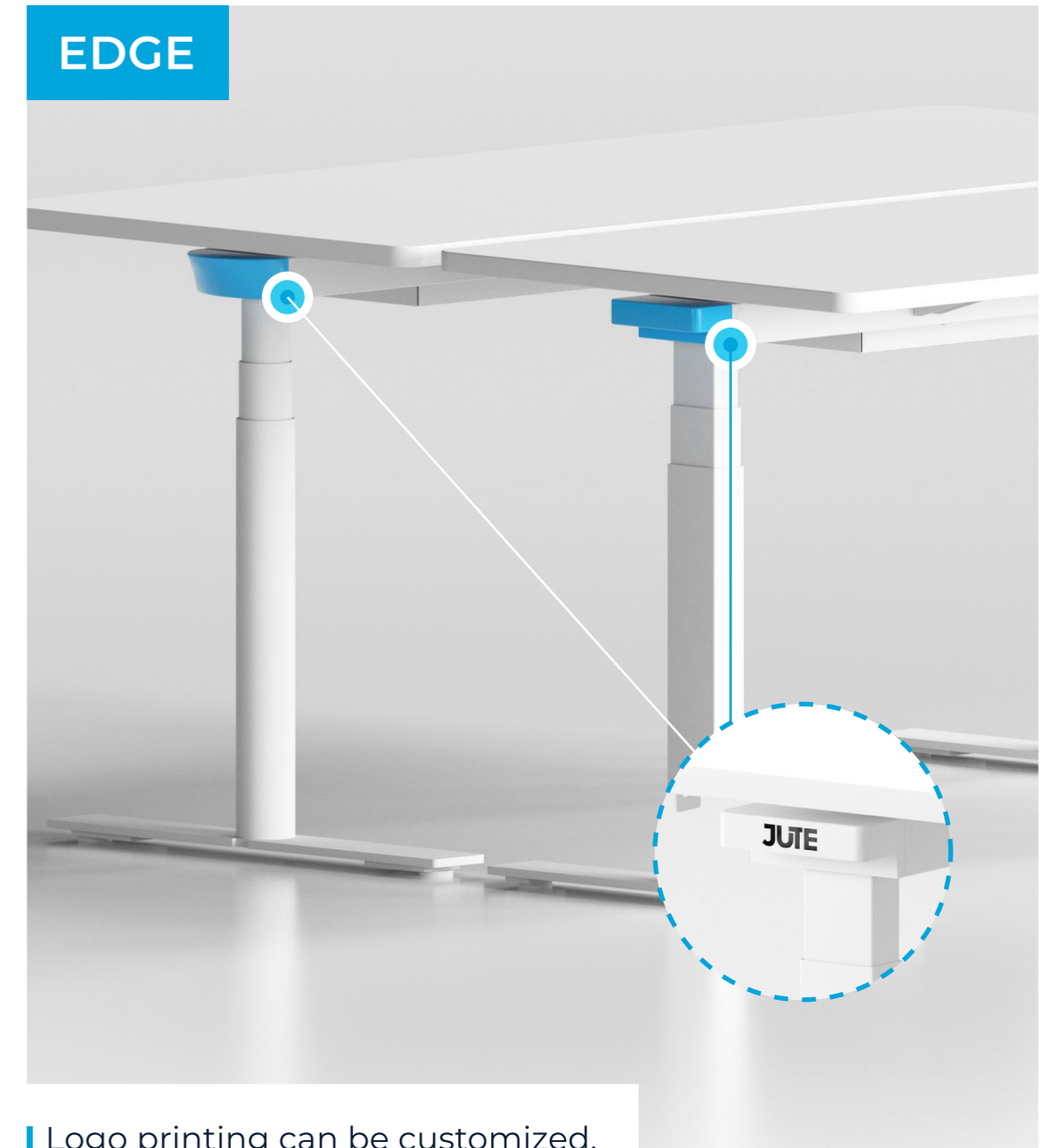

■ Logo printing can be customized.

CPU HOLDER

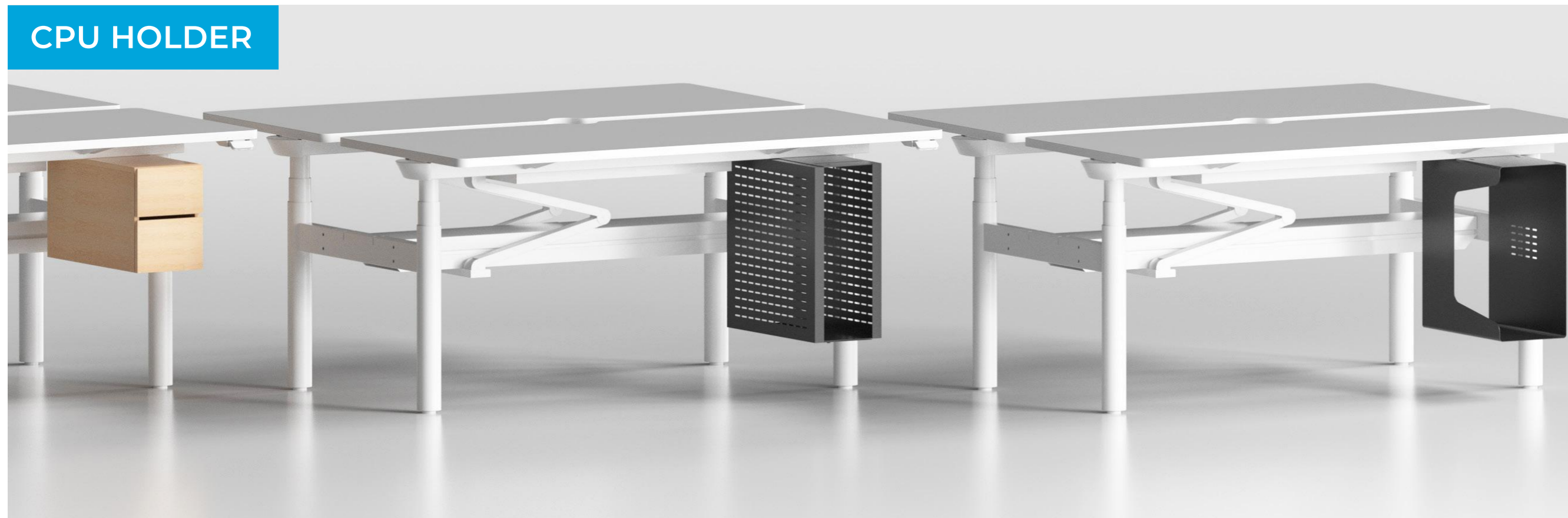

The ventilation hole is not only for cooling the temperature of the CPU operating, but also for a design feature for the hanging accessories.

If it is using the laptop, there is an options for the hanging drawer. It is alternative with wooden or metal options.

INSPIRING

Options

Jute offers a variety of combination options, allowing you to mix and match from the most popular colors among our customers. If these colors don't meet your needs, please contact our sales team for more options.

Controller



Desk Frame

Powder-coat

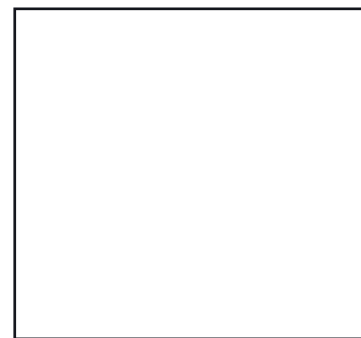

MET-002



MET-004



MET-007



MET-008



MET-010



MET-011



MET-012

Tabletop

Melamine

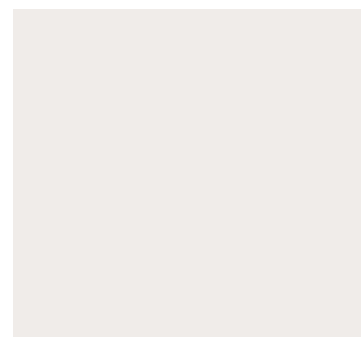

WK-301

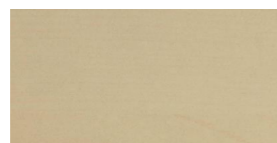

WK-306



WK-308

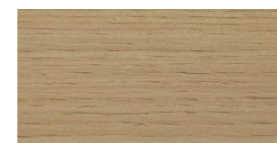

WK-310

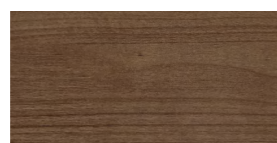

WK-314

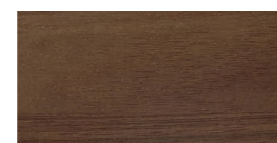

WK-316

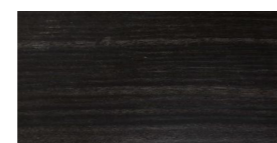

WK-318

Acoustic Screen

Pet

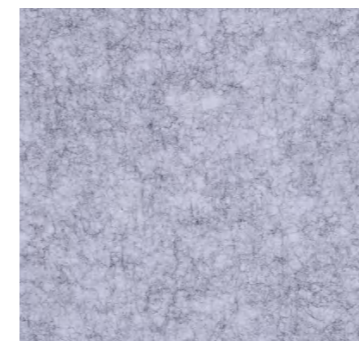

GP-03



GP-01



GP-04

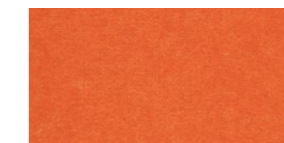

GP-06

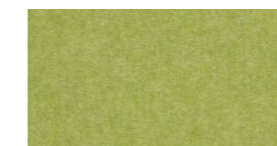

GP-12

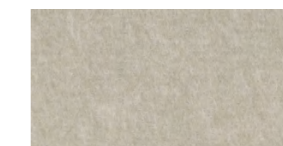

GP-14



GP-18



GP-121



GP-19



GP-33

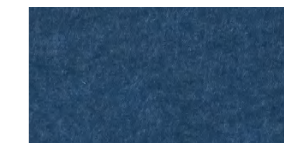

GP-51

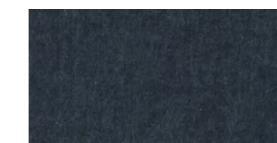

GP-57

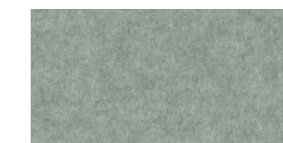

GP-93

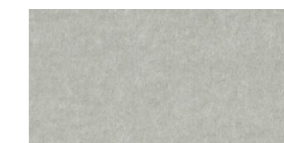

GP-95

Upholstery Screen

Small pear

GRADE A

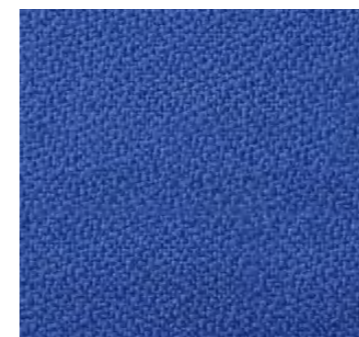

15-44



15-03



15-05

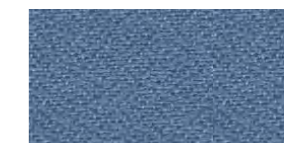

15-06



15-17

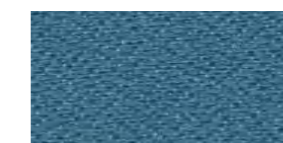

15-19



15-21

Inspiration

Office Space

Quickly understand the dimensions of your chosen product for easy pairing. Based on this, you can choose between round ($\Phi 70\text{MM}$) and square ($80 \times 50\text{MM}$) tubes.

Single & Free Standing

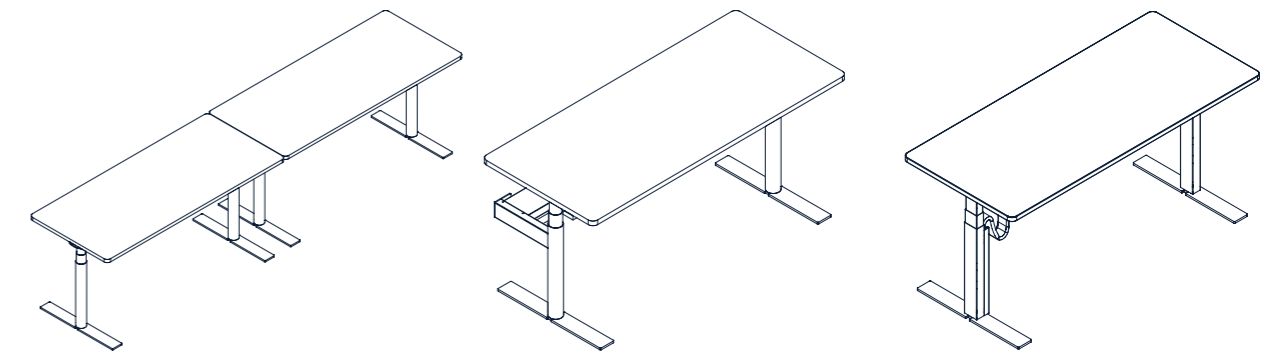
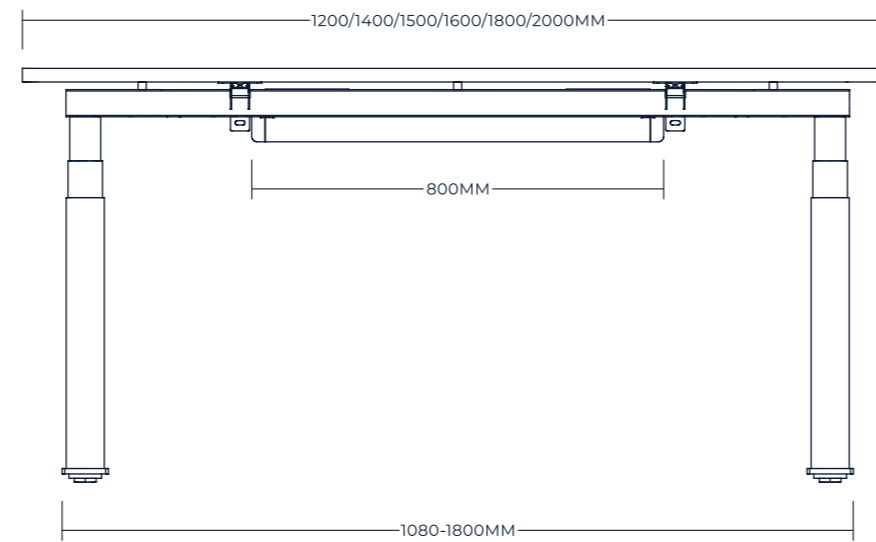
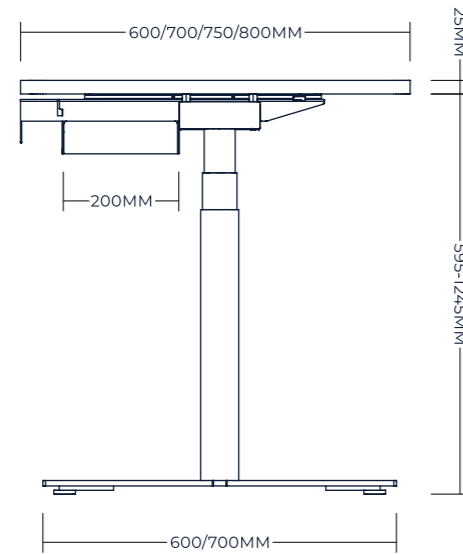

Matching combination

Bench & B2B Workstation

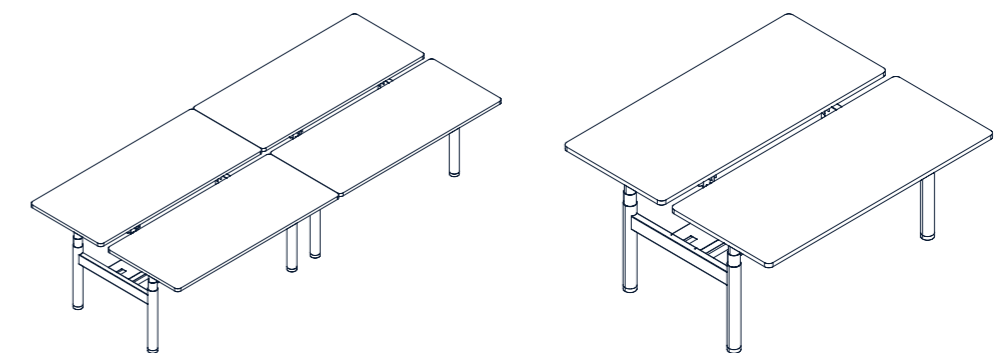
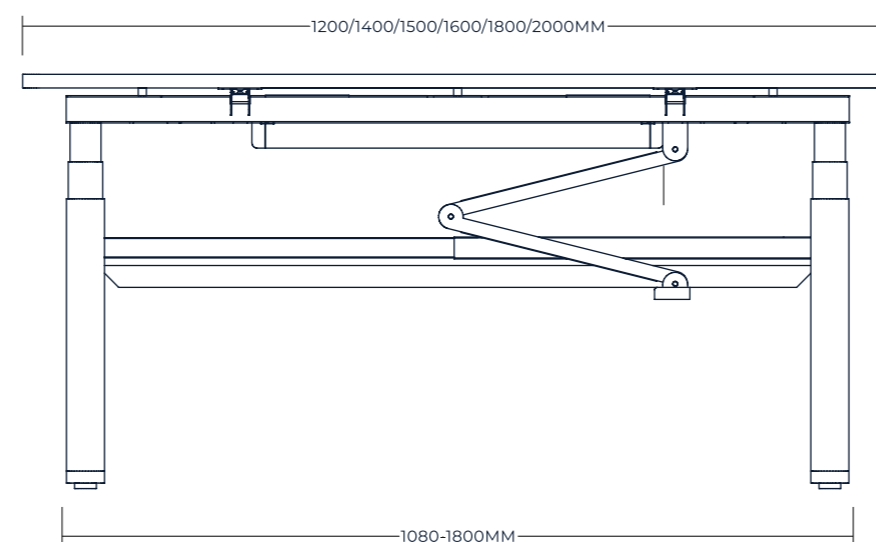
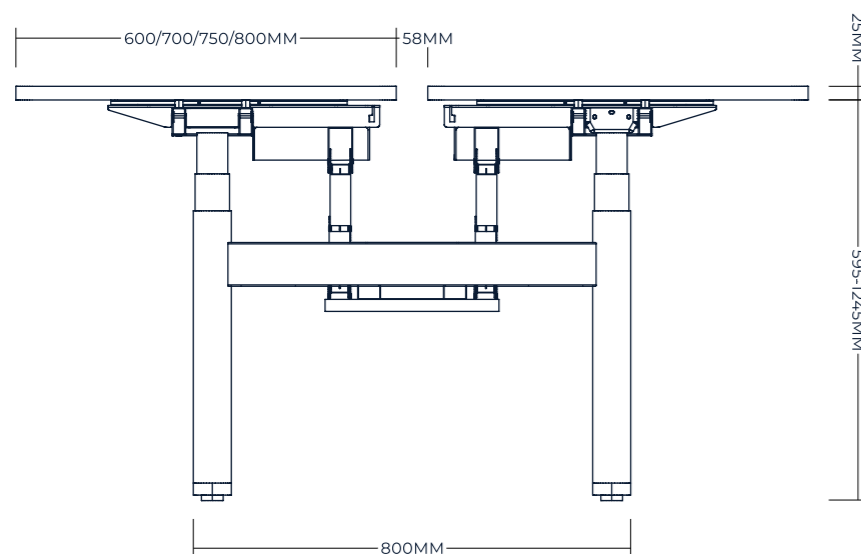

Matching combination

Office Space

Based on jute modular design, you can freely mix and match, including but not limited to existing combinations, to arrange your space according to your ideas.

Corner Workstation

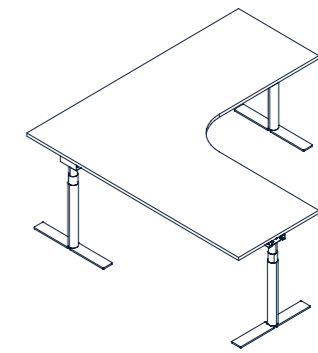
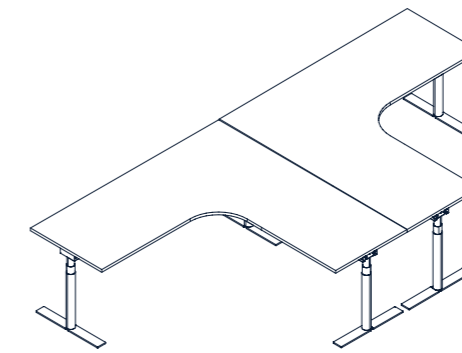
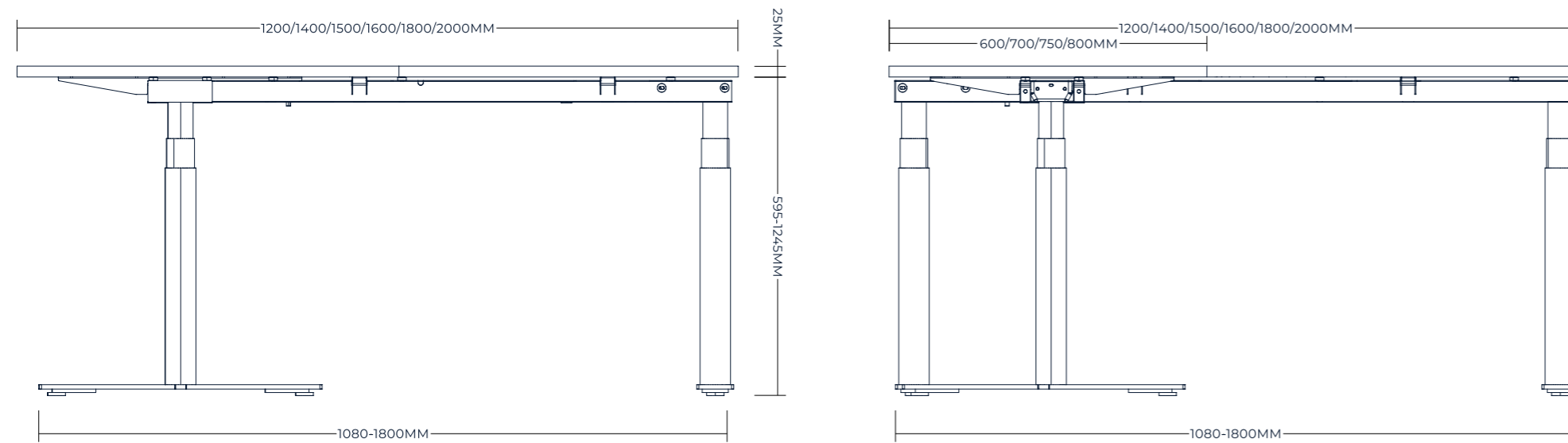

Matching combination

3-Way Workstation

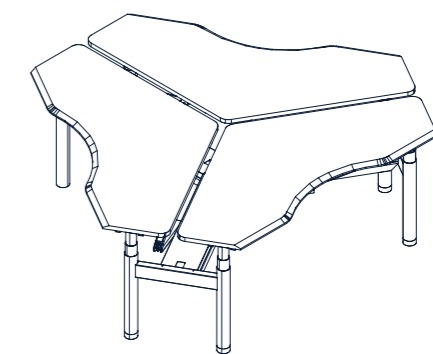
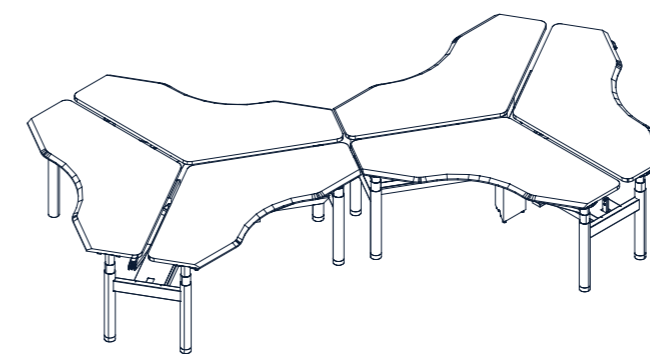
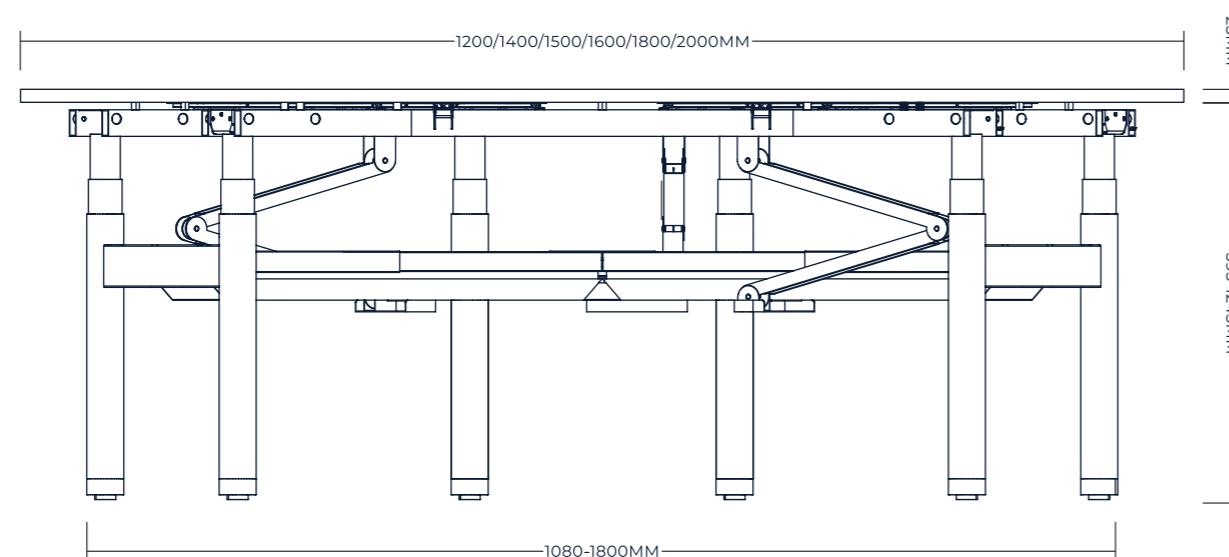

Matching combination

Private Offices

Jute offers executive desks that are both functional and aesthetically pleasing. Designed for executives, these desks provide ample workspace, integrated storage, and a refined look that enhances the office environment.

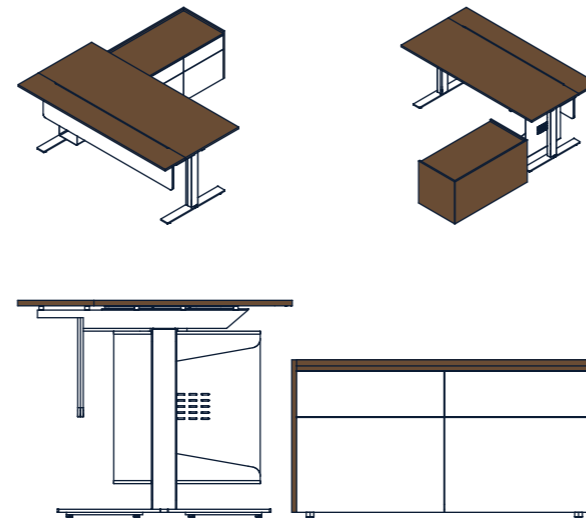
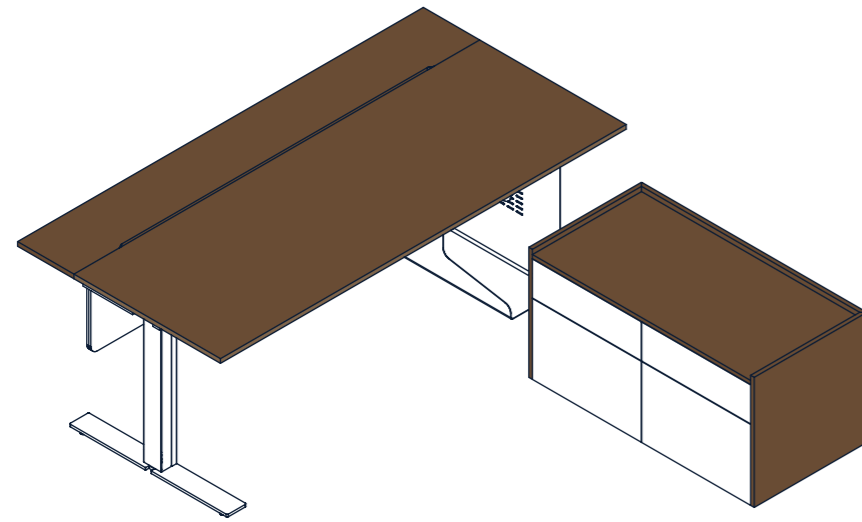

Manager desk with mobile storage

Desk	1800/2000W*900D*710-1210H
Storage	1000W*500D*675H
Modesity panel	1600/1800W*18MM*350H

Modesity panel can be metal or pet;
Mobile cabinet sizes can be customized;

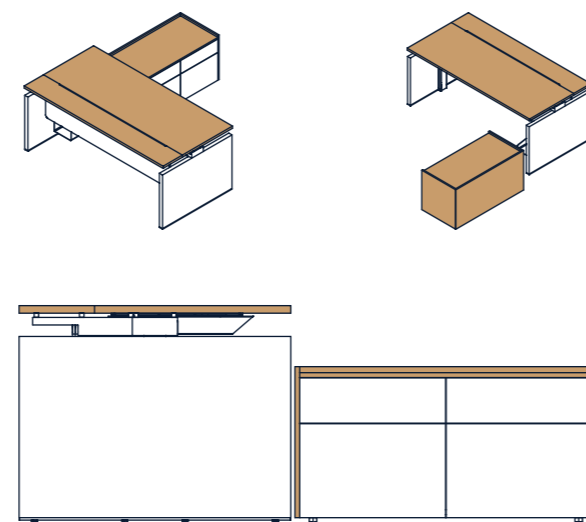
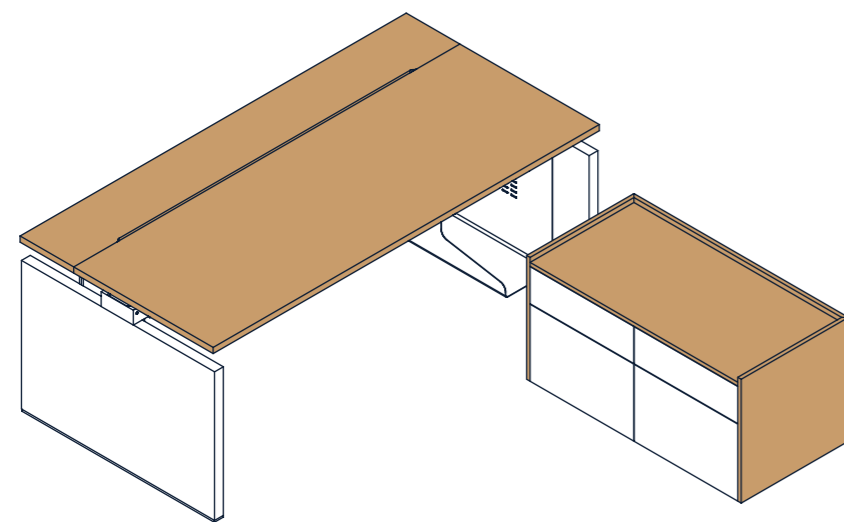

Manager desk with cover legs with mobile storage

Desk	1800/2000W*900D*710-1210H
Storage	1000W*500D*675H
Modesity panel	1600/1800W*18MM*350H

Modesity panel can be metal or pet;
Mobile cabinet sizes can be customized;

All color options are consistent with the workstation system.

Private Offices

Jute offers executive desks that are both functional and aesthetically pleasing. Designed for executives, these desks provide ample workspace, integrated storage, and a refined look that enhances the office environment.

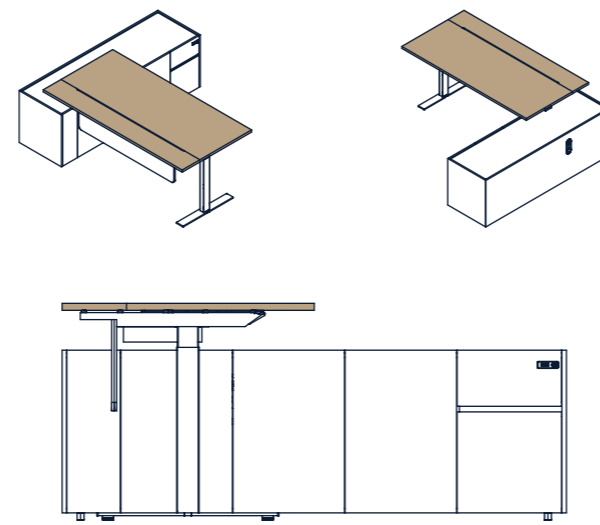
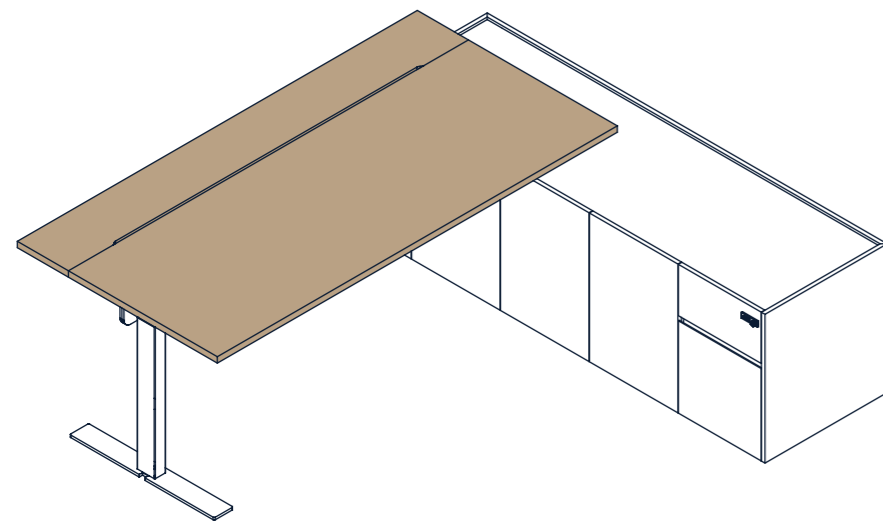

Manager desk with fixed storage

Desk	1800/2000/2200W*900D*710-1210H
Storage	1800W*550D*605H
Modesity panel	1200/1400/1600W*18MM*350H

Modesity panel can be metal or pet;
Fixed cabinet sizes can be customized;

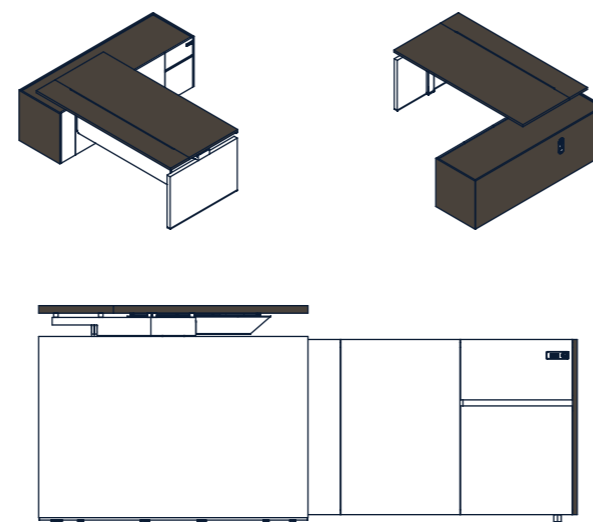
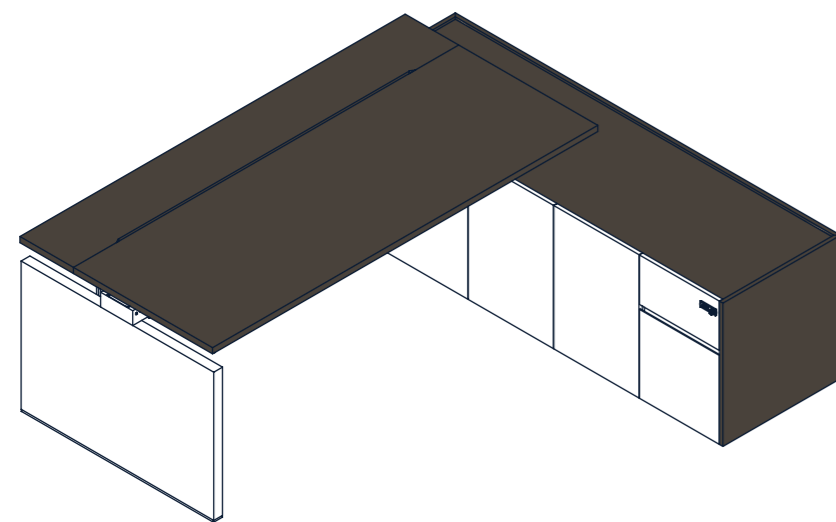

Manager desk with cover legs with fixed storage

Desk	1800/2000/2200W*900D*710-1210H
Storage	1800W*550D*605H
Modesity panel	1250/1450/1650W*18MM*350H

Modesity panel can be metal or pet;
Fixed cabinet sizes can be customized;

All color options are consistent with the workstation system.

Meeting and Reception Areas

Jute also offers meeting and reception areas with a unified design concept. Each space is tailored to meet its specific function, ensuring a cohesive and professional office appearance; you can choose between round ($\Phi 70\text{MM}$) and square ($80*50\text{MM}$) tubes.

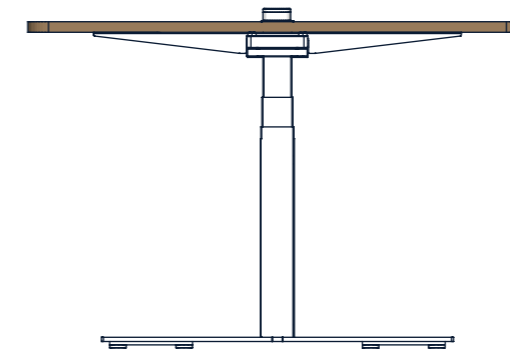
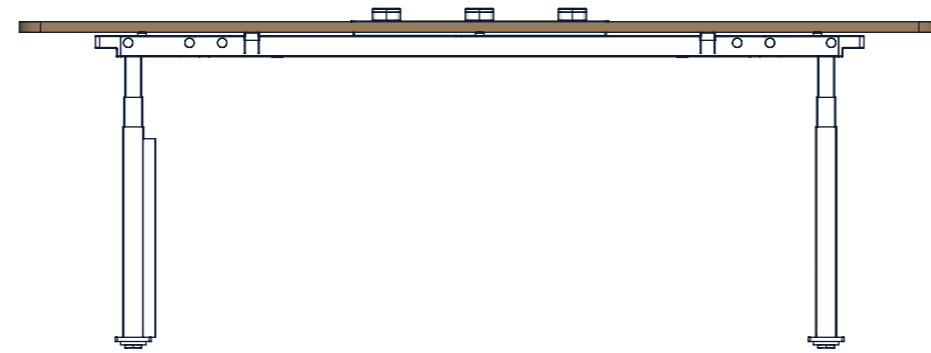
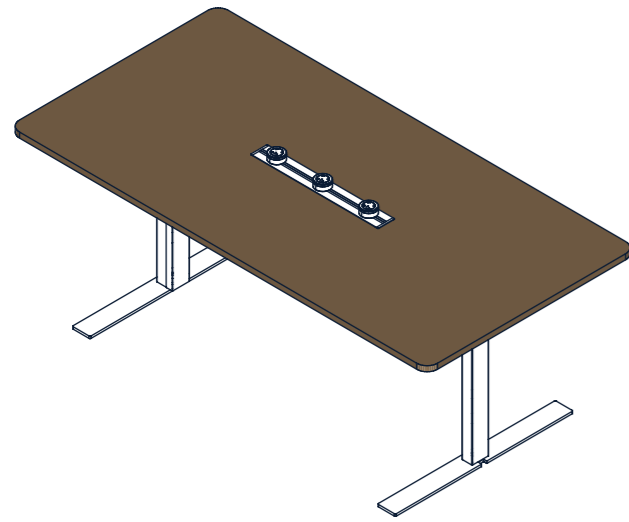

Meeting table

2000/2400W*1000/1200D*585-1232H

Customizable colors

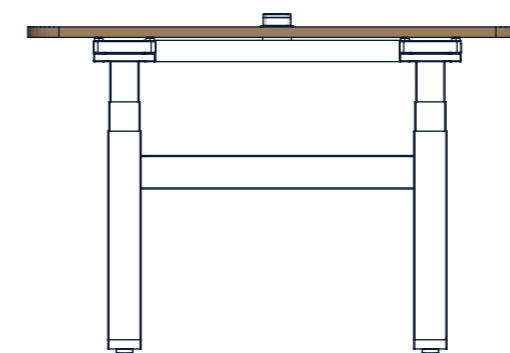
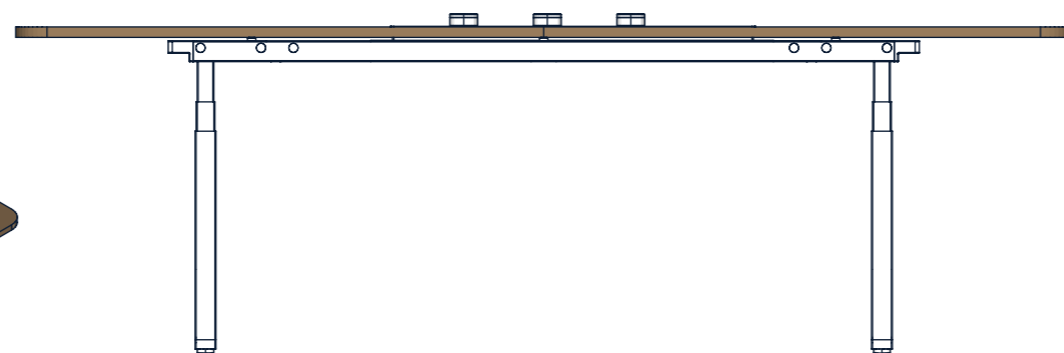
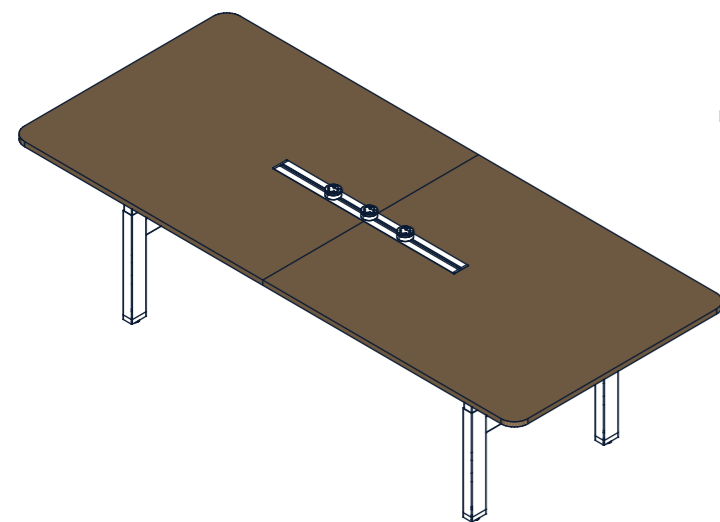

Meeting table

2800/3000W*1200D*585-1232H

Customizable colors

All color options are consistent with the workstation system.

PRESENTATING

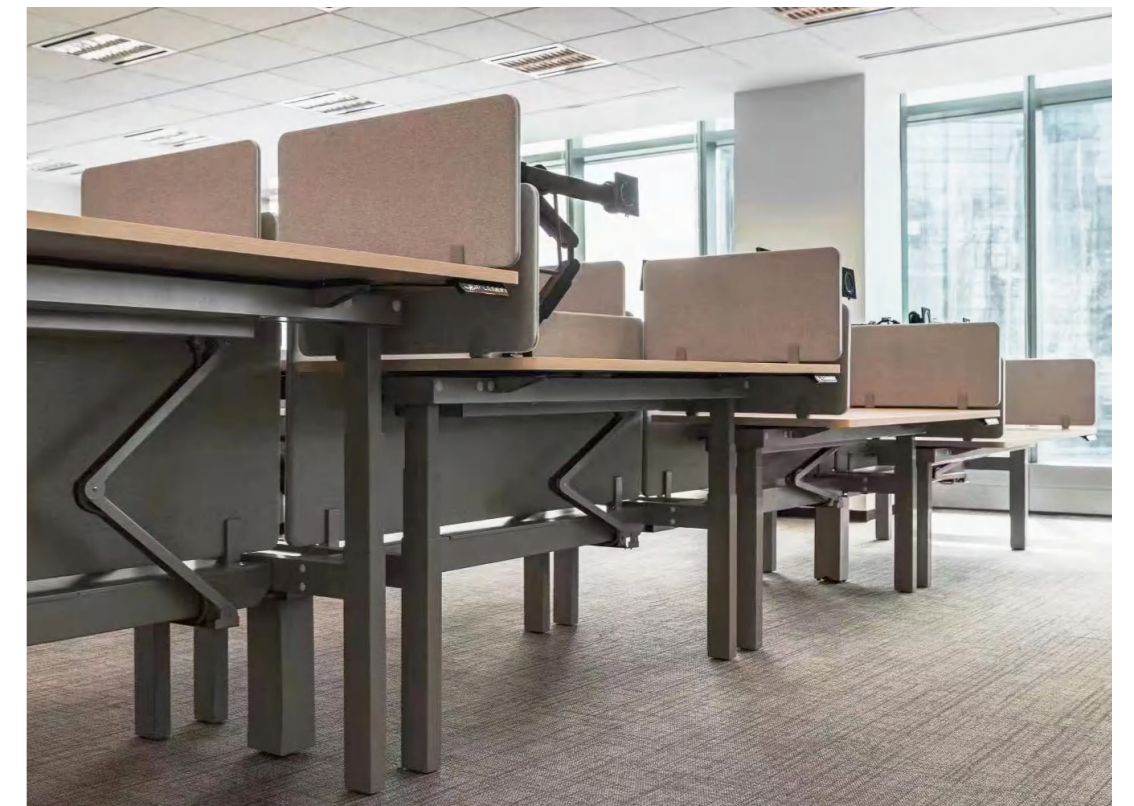

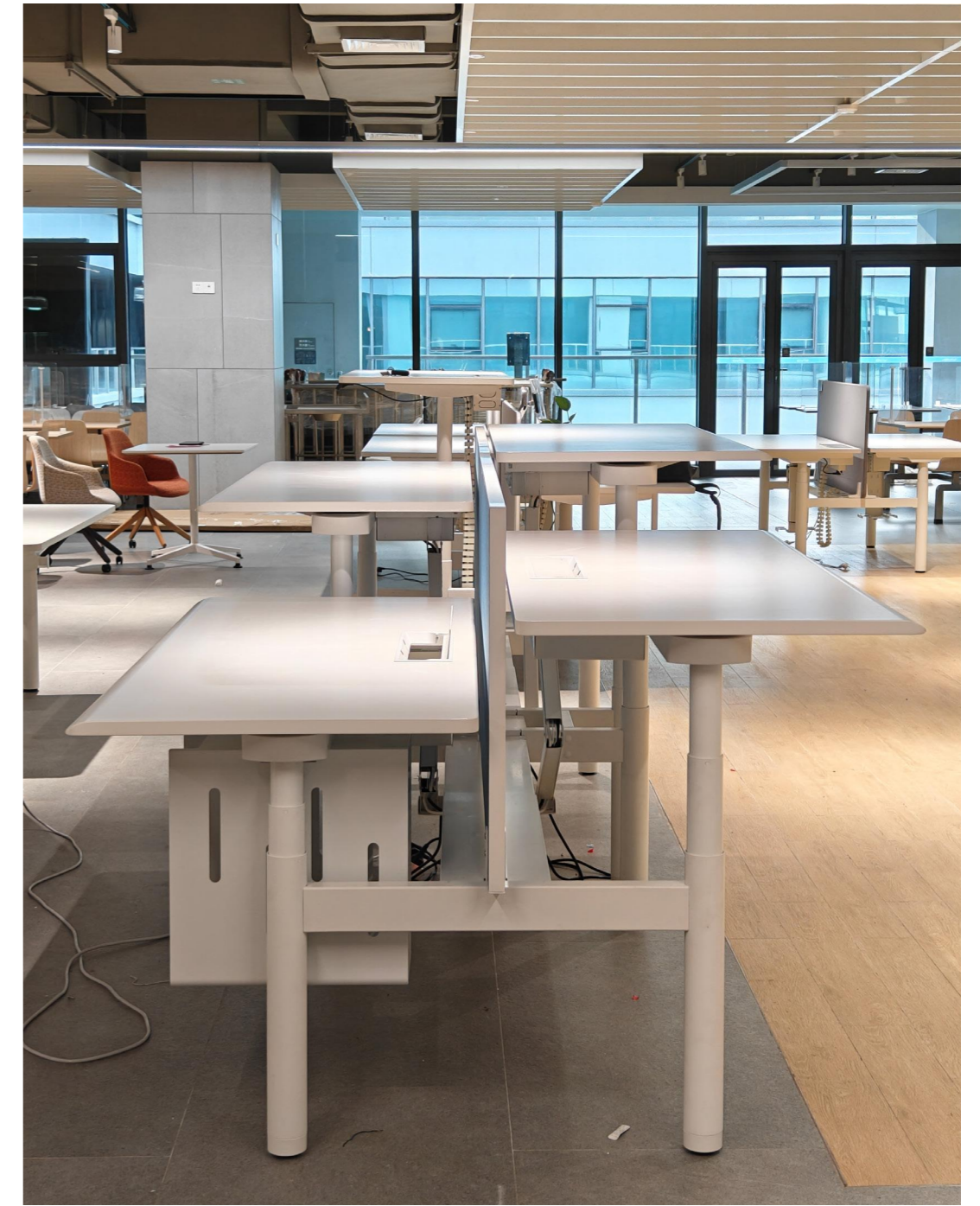













Workplaces impact performance and well-being.

A well-conceived workplace supports an organization's strategic goals, fosters its culture, and inspires its employees. atwoka works closely with our customers to develop flexible and affordable workplace solutions that help our customers meet their ever evolving business needs.